

PROJECT REVIEW COVER MEMO

TO: LAMOILLE BASIN WATER QUALITY COUNCIL (BWQC)
FR: LAMOILLE BASIN CLEAN WATER SERVICE PROVIDER (CWSP) STAFF
RE: SPECIAL MEETING ON 12/19/24
DA: DECEMBER 12, 2024

=====

Greetings, all. A special meeting will be held during the noon hour on December 19th. The focus of the meeting will be to continue and (it is hoped) conclude the review of the application received in response to the round 6 “Call for Projects.”

To recap, the project will restore portions of the floodplain located at the Dorothy Smith Access Area in Cambridge. The applicant (Vermont Fish and Wildlife Department) seeks \$219,265 for a project with annual phosphorus reduction estimated (by project designer) at less than 3 kilograms.

As mentioned previously, CWSP staff have concerns regarding relatively low cost effectiveness of the project and recommend awarding only partial funding.

AGENDA

Lamoille Basin Water Quality Council (BWQC)
Thursday, December 19, 2024 (this is an special meeting)
12:00-1:00 PM

Remote /Zoom meeting
(Zoom details below)

1. Welcome and introductions
2. Meeting protocols
3. Conflict of interest declarations, if any
4. Review/adjust and approve agenda
5. Approval of minutes
6. Public comment not related to items on agenda
7. Review of Application filed in response to round 6 "Call for Projects"
8. Conclusion

Please Note: The schedule for the upcoming application round in Lamoille Basin is as follows:

Round #	Open	Deadline
7	February 6, 2025	March 13, 2025
8	April 3, 2025	May 8, 2025

Join Zoom Meeting

<https://us02web.zoom.us/j/86562460349?pwd=dCtISjdHSGI1OFZ6Z2ZndTRPQ1pRQT09>

Meeting ID: 825 5958 8885

Passcode: 087018

One tap mobile +13052241968,,82559588885# US

Dial by your location

+1 309 205 3325 US

+1 646 558 8656 US (New York)

Staffing provided by Northwest Regional Planning Commission (NRPC), the Basin 6 Clean Water Service Provider. NRPC's physical / mailing address is 75 Fairfield Street, St. Albans, Vermont 05482.

In accordance with provisions of the Americans with Disabilities Act (ADA) of 1990, and Vermont's Open Meeting Law, the NRPC will ensure public meeting sites are accessible to all people or provide an opportunity to request accommodations. Requests for free interpretive or translation services, assistive devices, designation of a physical meeting location, electronic access to a meeting, or other requested accommodations, should be made to Amy Adams, NRPC Title VI Coordinator, at 802- 524-5958 or aadams@nrpcvt.com, no later than 2 business days prior to the meeting for which services are requested.

1. Welcome and introductions

2. Meeting protocols

Zoom Norms and Inclusive Language

- Introductions of all participants at each meeting
- As possible, BWQC members should have in their Zoom Name/Title the following: Name, Organization, “Voting” or “Alternate”, and pronouns (if desired)
- BWQC members are expected to have cameras turned on during entirety of meeting, as technically possible.
- BWQC members are expected to stay focused / avoid multi-tasking and follow the guidance of: “if you wouldn’t do something in an in-person meeting don’t do it in a virtual meeting”
- BWQC members will use the “raise hand” function on Zoom to indicate a request to speak / come off mute – this is in an effort to make sure all are heard in turn.
- All members will stay muted until called upon; if needed, CWSP staff may mute participants to avoid background noise
- Any comments made in the chat will be read aloud at the appropriate time by the CWSP staff in full for the public record / record.

Inclusive Language

<https://pronouns.org/what-and-why>

3. Conflict of interest declarations, if any

4. Review/adjust and approve agenda

AGENDA

Lamoille Basin Water Quality Council (BWQC)
Thursday, December 19, 2024 (this is an special meeting)
12:00-1:00 PM

Remote /Zoom meeting
(Zoom details below)

1. Welcome and introductions
2. Meeting protocols
3. Conflict of interest declarations, if any
4. Review/adjust and approve agenda
5. Approval of minutes
6. Public comment not related to items on agenda
7. Review of Application filed in response to round 6 “Call for Projects”
8. Conclusion

Please Note: The schedule for the upcoming application round in Lamoille Basin is as follows:

Round #	Open	Deadline
7	February 6, 2025	March 13, 2025
8	April 3, 2025	May 8, 2025

Join Zoom Meeting

<https://us02web.zoom.us/j/86562460349?pwd=dCtISjdHSGI1OFZ6Z2ZndTRPQ1pRQT09>

Meeting ID: 825 5958 8885

Passcode: 087018

One tap mobile +13052241968,,82559588885# US

Dial by your location

+1 309 205 3325 US

+1 646 558 8656 US (New York)

Staffing provided by Northwest Regional Planning Commission (NRPC), the Basin 6 Clean Water Service Provider. NRPC’s physical / mailing address is 75 Fairfield Street, St. Albans, Vermont 05482.

In accordance with provisions of the Americans with Disabilities Act (ADA) of 1990, and Vermont’s Open Meeting Law, the NRPC will ensure public meeting sites are accessible to all people or provide an opportunity to request accommodations. Requests for free interpretive or translation services, assistive devices, designation of a physical meeting location, electronic access to a meeting, or other requested accommodations, should be made to Amy Adams, NRPC Title VI Coordinator, at 802- 524-5958 or aadams@nrpcvt.com, no later than 2 business days prior to the meeting for which services are requested.

5. Approval of minutes

Lamoille Basin Water Quality Council (BWQC)

Wednesday, December 4, 2024 (this is an adjusted meeting date due to Thanksgiving)

9:00 -11:00 AM

Remote /Zoom meeting

Meeting video posted at <https://youtu.be/HHA5ycyGSSU>

**A VIDEO RECORDING OF THE MEETING IS AVAILABLE THROUGH THE
NRPC YOUTUBE CHANNEL (Link above).**

**THE WRITTEN MINUTES ARE A SYNOPSIS OF THE DISCUSSION AT THE MEETING.
MOTIONS ARE AS STATED. MINUTES WILL BE SUBJECT TO CORRECTION BY THE
COUNCIL. CHANGES, IF ANY, WILL BE RECORDED IN THE MINUTES OF THE NEXT
MEETING OF THE COUNCIL**

Council Members: Lauren Weston (Q), Meghan Rodier (Q), Ken Minck (Q), Christine Armstrong (Q), Erin De Vries (Q), Richard Goff, Daniel Koenemann

Q= towards quorum

Staff: Dean Pierce, Cliff Jenkins, Nora Brown

Others present: Peter's AI Notetaker, Jessica Louisos, Mike Wichrowski, Karen Bates, Ted Sedell

1. Welcome and introductions

Dean Pierce opened the meeting at 9:07 am as CWSP staff member.

A discussion was had about who should run the meeting, as both the Chair and Vice Chair were unable to attend. Members agreed to allow Dean Pierce to run the meeting in their absence.

A round of introductions was made.

2. Meeting protocols

Dean Pierce reviewed norms for meeting on Zoom.

3. Conflict of interest declarations, if any

Meghan Rodier indicated that she would be recusing herself from discussion of the application filed in response to the sixth round Call for Projects as staff of the applicant, Lamoille County Planning Commission.

Richard Goff also indicated that she would be recusing himself as a Lamoille County Planning Commission board member.

4. Review/adjust and approve agenda

Erin De Vries motioned to approve the agenda. Dan Koenemann seconded. Motion carried.

5. Approval of minutes

Dan Koenemann motioned to approve the minutes. Ken Minck seconded. Erin De Vries abstained as she was not at the meeting. Motion carried.

6. Public comment not related to items on agenda

No public comments were made.

7. Report on budget adjustments, if any

No budget adjustments reported.

8. Review of Application filed in response to round 6 “Call for Projects”

Dean Pierce reviewed the application made by Vermont Fish and Wildlife Department for the implementation phase of the Dorothy Smith Access Area Floodplain Restoration Project. He noted that VFWD was recently pre-qualified to implement CWSP projects through NRPC’s rolling pre-qualification process.

Meghan Rodier presented the project as regional planner for the Lamoille County Planning Commission. She reviewed the project’s eligibility for CWSP funding, background, scope, timeline, benefits, and funding to date for design and permitting. The project is seeking implementation funding of \$219,265, which includes construction, construction oversight, project management by LCPC, and 3-years of post-monitoring and O&M costs. LCPC has not secured other implementation funding, but the project is considered to be “shovel-ready.”

Mike Wichrowski provided a historical overview of VFWD’s acquisition and stewardship of the site. He described past stormwater erosion and subsequent restoration work at the site that led VFWD to identify and develop this floodplain restoration project.

Jessica Louisos shared more about SLR Consulting’s past work in the area that identified the site as a priority for floodplain restoration through both hydrological mapping and the stormwater management plan.

Dean Pierce noted that the project does not meet CWSP cost effectiveness standards. He also mentioned an outstanding question for DEC about whether the requirement for a site access easement rather than a license because funding cost is over \$200,000 still applies when site is owned by a state agency.

Dan Koenemann shared that other CWSPs have dealt with these situations by funding partially up to cost effectiveness. Dean Pierce added that this doesn’t totally solve the problem, because phosphorus credits may have to be shared with other funders.

Jessica Louisos shared that the amount of impervious surface removal that the project involves provides a major benefit that might not be captured in the phosphorus reduction numbers.

Ken Minck expressed confusion about the project's classification as non-regulatory, as it involves a site owned by a state agency.

Meghan Rodier clarified that the project is entirely voluntary and thus non-regulatory.

Dean Pierce explained that projects are regulatory when the practices being implemented are required by legislation and/or rules rather than chosen by a landowner. He also noted that DEC funding policy explicitly states that state agencies are eligible for CWSP funding.

Dan Koenemann shared that he would be open to funding the project if the CWSP is otherwise in a good position in terms of meeting its phosphorus reduction quota with available funding.

Dean Pierce noted that only one project has been completed that included a phosphorus reduction, namely the Ten Bends tree buffer planting, which along with several other projects in process leaves the CWSP in a good place quota-wise. He noted that the target cost of phosphorus reduction when DEC developed the formula for distributing Clean Water Funds was approximately \$14,000 per kilogram, with stream-oriented projects generally being the most cost effective. Cost effectiveness for this project is poorer than the CWSP is generally comfortable with, particularly if credits would have to be shared. Thus, CWSP approval may depend on whether remaining funding comes from an entity that also reports phosphorus credits. He stated that \$75,000 in total CWSP funding for the project might be tolerable, with any higher figures causing concern.

Ken Minck shared that he thinks \$219,000 is outside of the BWQC's recommendations for 3kg of reduction.

Erin De Vries disagreed, stating that \$219,000 is reasonable when including additional co-benefits and all implementation costs.

Dan Koenemann agreed with Erin De Vries but noted that DEC regulation essentially means only phosphorus reduction numbers can be considered.

Erin De Vries asked about the process for calculating co-benefits.

Dean Pierce shared there is a calculation in ranking system that considers co-benefits, but that it is really most useful when choosing between projects.

Lauren Weston expressed strong support for funding this project. She felt that otherwise the message would be sent that BWQCs can't get anything done, even on state-owned land in a flood-prone area. Since much work and money has already gone into this project, and since not a lot of projects are submitted to the BWQC for funding, she felt it is important to get something done rather than nothing, particularly for community engagement.

Dan Koenemann asked whether, were the project to be funded as proposed, a message would be sent that the BWQC is willing to fund projects at any level of phosphorus reduction and cost effectiveness.

Lauren Weston shared that she is willing to live with a bad precedent in that case.

Ken Minck asked about what was spent on the preliminary phases leading up to implementation, since these phases were not funded by the CWSP.

Meghan Rodier shared that \$40,000 was spent for final design and SLC's time for permitting, plus an additional archaeological assessment funded by VFWD. She couldn't provide figures for preliminary design, as it was completed as part of the stormwater master plan and hard to separate from the rest of the plan.

Ken Minck again expressed a desire to stay within cost effectiveness guidelines, even for otherwise attractive projects.

Dean Pierce noted that cost effectiveness numbers are best practices and not rules. He reminded members that while the CWSP needs BWQC approval to issue a task order, BWQC recommendations are not a mandate to the CWSP.

Lauren Weston noted that these cost effectiveness standards are based on outdated construction projects and incomplete plans meaning it might be unlikely to ever get a proposal that meets cost effectiveness standards given increasing costs. She shared that while she understands that CWSP needs to follow these rules, she finds it frustrating that CWSP staff ultimately decide rather than BWQC, which doesn't seem to be what legislators intended for community ownership of projects.

Dean Pierce pointed out it did not appear the council would meet quorum requirements to hold a successful vote (five votes required to approve).

Ken Minck suggested approving \$195,000 to avoid the requirement for a site access easement. Dean Pierce clarified that under current DEC policy the project would still require an easement if total implementation costs exceed \$200,000 in state funding. Mike Wichrowski shared that VFWS lawyers were of the opinion that an easement likely isn't required for a project on state lands and an alternative could be negotiated.

Discussion then followed of the structure of alternates for absent council members, particularly whether each alternate may only replace one specific member or fill in as needed.

A straw poll of council members was conducted to gauge support for the project. The project was not determined to have enough votes in favor to receive funding at this time, but as quorum was not met an official vote could not be held.

Lauren Weston motioned to table the application and call a special meeting to discuss the project at the soonest possible date. Erin De Vries seconded. Motion carried.

9. Training: O&M procedures and systems and costs

With limited time, Dean Pierce suggested moving forward to the project status round table. Members agreed to revisit this agenda item at a future meeting.

10. Round Table: Status of projects

Ted Sedell provided an update on Orleans County NRCD's project on the Barr Property on Caspian Lake. He shared that the NRCD had contracted with Fluid State for design and permitting. They had also successfully delineated the wetland and conducted site visit with Staci Pomeroy of DEC. They have scheduled a meeting on January 21 to discuss design, after which they would have a good sense of 60% design for review.

Erin De Vries shared that Vermont River Conservancy will start work on a planning grant for the Lamoille River basin from Lake Champlain Basin Program in January. The project will include geomorphic assessments in river corridors for prioritization mapping, followed by ground truthing in the summer. VRC is hoping to start bringing projects identified through this process to the BWQC by the end of 2025.

Dean Pierce shared that Ken Minck was recently involved in a completed gully project in Basin 5. He expressed interest in finding more of these projects in the Lamoille Basin since they score so well with phosphorus reduction, even if they can be hard to fund.

11. Updates/Brief announcements

Dean Pierce reminded members that the next two funding rounds open February 6 and April 3, respectively.

12. Future meeting topics

The next regular meeting of the Lamoille BWQC is scheduled for January 23, 2025. Dean Pierce agreed to send a poll to members to schedule a special meeting for continued discussion of the Dorothy Smith Floodplain Restoration project.

Ken Minck requested future discussion to provide more clarity on the use of alternates for absent council members, namely whether alternates may only replace one member or whether they may replace whoever is absent.

13. Conclusion

Meghan Rodier motioned to adjourn. Ken Minck seconded. Motion carried. Meeting adjourned at 10:49am.

6. Public comment not related to items on agenda

7. Review of Application filed in response to round 6 “Call for Projects”

PROJECT REVIEW COVER MEMO

TO: LAMOILLE BASIN WATER QUALITY COUNCIL (BWQC)
FR: LAMOILLE BASIN CLEAN WATER SERVICE PROVIDER (CWSP) STAFF
RE: APPLICATION UNDERGOING REVIEW ON 12/4/24
DA: NOVEMBER 27, 2024

=====

One application was received in response to the round 6 “Call for Projects.”
The project will restore portions of the floodplain located at the Dorothy Smith Access Area in Cambridge.
The applicant (Vermont Fish and Wildlife Department) seeks \$219,265 for a project with annual phosphorus reduction estimated (by project designer) at less than 3 kilograms.
CWSP staff, including Director, have significant concerns regarding relatively low cost effectiveness and would advise awarding only partial funding.
Additional details will be provided on December 4.

DATA ENTRY /Prelim results

*

WPD ID	Project type	Annual p reduction kg	Any one time P reduction kg	Funding request (next project stage)	Proposed cost (next project stage)	Estimated Total cost (all project stages) using midpoint of ranges	cost per kg annual P reduction	design life (yr)	Estimated annual maintenance costs	D	E	F
12281	Floodplain/Stream Restoration - Implementation	3.20	6.80	\$219,265.00		\$219,265.00	\$68,520	15	3400	\$1,063	10	3
	Description											

This project will restore riparian habitat and floodplain access at the Dorothy Smith Access Area by reducing impervious surface along the parking lot, removing gravel built up on the floodplain, re-vegetating the floodplain, and maintaining river access via a walking path. This project will provide floodplain access, enhance flood resiliency, and reduce sedimentation and stormwater runoff into the Lamolle River. The Access Area is located upstream of the confluence with the Brewster River and has historically experienced streambank erosion, sedimentation, and nutrient loading, especially near the Boat Access Area. This site was identified as a priority in the 2021 Cambridge Stormwater Master Plan and recognized as an erosion hot spot. Floodplain restoration on this Vermont Fish and Wildlife parcel will provide storage for flood water, ice, and debris. Located immediately upstream of the Route 108 bridge, this parcel provides a crucial location for ice, debris, and sediment to settle out, to reduce sedimentation inputs into the Lamolle and Brewster River.

WPD ID*	Project Manager / Sub-Grantee*	Project Name*	Project Description*	Project Type*	Town, County or Region*	Date Project Selected for Funding	Formula Grant Funding Amount Awarded*	Date Formula Grant Sub-Agreement Executed*	Estimated Annual Phosphorus Reduction (kg/yr)*	Cost per KG
11361	Lamolle County Conservation District	Rocky Woods Strategic Wood	Objective: The objective of this project is	Floodplain/Stream Restoration - Preliminary D	Elmore	3/23/2023	\$ 3,373.86	6/27/2023	10.26	
11774	Lamolle County Conservation District	Rocky Woods Strategic Wood Addition	Implement Strategic Wood Addition	Floodplain/Stream Restoration - Implementati	Elmore	4/3/2024	\$104,973.06	5/10/2024	11.19	\$9,380.97

Basic Eligibility	Yes
Applicant Name	Mike Wichrowski
Applicant Organization	Vermont Fish and Wildlife Department
Applicant Email	Mike.Wichrowski@vermont.gov
Applicant telephone	+1 (802) 917-1347
Project ID from WPD	12281
Description of Project	This project will restore riparian habitat and floodplain access at the Dorothy Smith Access Area by reducing impervious surface along the parking lot, removing gravel built up on the floodplain, re-vegetating the floodplain, and maintaining river access via a walking path. This project will provide floodplain access, enhance flood resiliency, and reduce sedimentation and stormwater runoff into the Lamoille River. The Access Area is located upstream of the confluence with the Brewster River and has historically experienced streambank erosion, sedimentation, and nutrient loading, especially near the Access Area. This site was identified as a priority in the 2021 Cambridge Stormwater Master Plan and recognized as an erosion hot spot. Floodplain restoration on this Vermont Fish and Wildlife parcel will provide storage for flood water, ice, and debris. Located immediately upstream of the Route 108 bridge, this parcel provides a crucial location for ice, debris, and sediment to settle out, to reduce sedimentation
Project Latitude	44.65127
Project Longitude	-72.82851
Project Phase	Implementation
Annual P Reduction KG	7 kg per year. See attached FFI Tool and VT DEC Phosphorus Reduction Calculator outputs.
Any one time P reduction KG	Year 1 storage P reduction is 15 kg per year 1.
Total Cost of Proposed Phase	\$269,200. Only applying for implementation phase (\$219,265). Final Design is complete. Permits have been drafted and forwarded to VFWD Commissioner for signature to be filed in November, 2024.
Amount of funding requested (Proposed Phase)	\$219,265.00
Matching Funds Available	\$2,523. VFWD covered the cost for an Archaeological Resources Assessment. Previous phases of this project were funded by DEC Design/Implementation Block Grants.
Total Project Costs (All Phases)	N/A. Seeking implementation funding only. See above total cost for this phase.
KG/\$ Current Phase	#INVALID OPERATION
KG/\$ Overall	#INVALID OPERATION
Design Life	Perpetual
Adjusted Design Life	
Estimated Annual O&M cost total	SLR estimated O and M/post monitoring cost up to the first three years will be approximately \$3,400 annually and up to \$10,200 total for the first three years post implementation.
Estimated Annual O&M Cost per KG	
Conformance with Tactical Basin Plan TBP	10
Number of Co-benefit Areas	3
DEC Screening Form Uploaded	Yes
Map of Project Area Uploaded	Yes
Project Budget Uploaded	Yes
Project Schedule Uploaded	Yes
Landowner Support uploaded	Yes
Phosphorus Calculator Tool uploaded	Yes
Created	11/14/24 8:16 AM
Design/Imp Costs Requested	219265
Design-Imp Costs Total	N/A. Seeking implementation funding only. See above total cost for this phase.
Cultural Resource Review	Yes

List of Attachments

- DEC Screening Form
- Completed DEC Calculator tool (or FFI Tool results)
- Proposed Project Budget
- Map of Project Area
- Proposed Project Schedule
- Indication of Landowner Support
- Final Sign off from VDHP
- 100% Design Plans
- Permits (To be filed November, 2024)

APPENDIX A. CLEAN WATER INITIATIVE PROGRAM - PROJECT ELIGIBILITY SCREENING FORM

This fillable PDF form is designed to assist with project review by systematically walking through all eligibility criteria. It should be completed for all projects seeking funding for 30% + design or implementation work. It may be applied to projects seeking funding for assessment or development if helpful for determining their alignment with eligibility criteria 2, 3, 6, and 8.

Step 1: Conduct Eligibility Criteria #1 Screening: Project Purpose

Table 1A: Project Purpose	
From the drop-down list to the right, please select which of the four objectives of Vermont's Surface Water Management Strategy this project addresses. If multiple, please list below: Minimize flood/ fluvial erosion hazards, minimize nutrient pollution, and protect/restore aquatic and riparian habitat	Multiple

a final design will have a different WPD-ID from a preliminary design even if for the same project). If the project, or the specific phase, is not yet in the Watershed Project Database, follow directions provided in the CWIP Funding Policy to secure a WPD-ID. Please see [CWIP Funding Policy](#) for more information on the WPD-ID.

Table 3A. WPD-ID	
Watershed Project Database ID number assigned	12281
Watershed Project Database Project Name	Dorothy Smith Access Area Floodplain Restoration

Step 4: Conduct Eligibility Criteria #4 Screening: Natural Resource Impacts³

Agency of Natural Resources (ANR) permit screening for natural resource impacts includes 1) an initial desktop review to identify which ANR permitting programs should be contacted, 2) a review by the relevant ANR permitting staff, and 3) a response summary from the project proponent addressing any permitting staff concerns. ⁴

- 1) **Table 4. Natural Resource Impacts** facilitates a high-level desktop review of the most likely ANR permits to apply to clean water projects. Project proponents should answer all the questions to identify likely permit needs. ⁵ Please note that “project site” may include both the active restoration location as well as any additional impact footprint related to staging, site access, or storage of waste or disposed materials.
- 2) If responses to the **Table 4. Natural Resource Impacts** desktop review trigger a permitting staff consultation, **Table 4** provides appropriate contact information.
 - a. Proponents should send the identified permitting staff the following:
 - i. The watersheds project database identification number (WPD-ID) (if available),
 - ii. Project location (GPS coordinates)
 - iii. Summary of proposed scope of work, and
 - iv. Any other relevant information they request that will be utilized in their review.
 - b. **Proponents should clarify they are seeking permitting staff input on potential permitting needs, permit-ability of proposed scope of work, and other design considerations but they are NOT seeking a formal permit determination.**
 - c. Project proponents must attempt to communicate with the permitting staff and provide them with at least thirty days to review the project and provide a

³ Easements and Riparian Buffer Plantings are excluded from this eligibility requirement/step.

⁴ In cases where this screening may have already occurred in a prior project phase, project proponents may supply attachments or links to relevant permit needs assessment documents in place of completing Table 4.

⁵ Entities selected for funding are expected to perform due diligence to ensure all applicable permits (including non-ANR state, local, and federal permits) are discovered and secured prior to implementation. The [ANR Permit Navigator](#) and an Environmental Compliance Division Community Assistance Specialist can help confirm ANR permitting needs for any projects once selected for funding.

response. Project proponents are encouraged to perform this screening during a project development phase as opposed to during a project solicitation round to allow for more time for feedback. Permitting feedback may be up to one year old.

- 3) Proponents should summarize permitting staff feedback and how the proposed scope of work will address this at the bottom of **Table 4**. Specifically, please include:
 - a. Which permits or permit amendment are needed or might be needed?⁶
 - b. What type might be needed? (e.g., a general or individual permit⁷)?
 - c. What concerns were voiced by permitting staff?
 - d. How will the proposed scope of work address these concerns?⁸

Table 4A: Natural Resource Impacts		
I. Act 250 Permits		
1. Have any Act 250 (Vermont’s Land Use and Development Control Law) Permits been issued in the project site’s parcel location?⁹	Yes <input type="radio"/>	No <input checked="" type="radio"/>
If yes , please provide the permit number and list any water resource issues or natural resource issues found ¹⁰ :		
PermitNumber: _____		
ResourceIssues: _____		
If yes , use the Water Quality Project Screening Tool to identify the appropriate regulatory contact for an Act 250 consultation.		
Regulatory Point of Contact Name/Position: _____		
II. Lake and Shoreland		
1. Is the project site located within 250 feet of the mean water	Yes <input type="radio"/>	No <input checked="" type="radio"/>

⁶ Occasionally permit staff may indicate they need a field visit or to see more completed designs prior to making a permit need determination.

⁷ Design phase projects that require an individual wetlands permit must have the permit in hand at the close of the final design phase. Implementation phase projects must have the individual permit in hand to be eligible for funding.

⁸ Examples could include planned design changes or inviting permitting staff to stakeholder meetings.

⁹ An Act 250 Permit is required for certain categories of development, such as subdivisions of 10 lots or more, commercial projects on more than one acre or ten acres (depending on whether the town has permanent zoning and subdivision regulations), and any development above the elevation of 2,500 feet. The [ANR Atlas Clean Water Initiative Program Grant Screening tool](#) can help answer this yes/no question. Follow the instructions on the link above to identify whether your project is located on an Act 250 parcel. Note that the layer to activate in ANR Atlas is now named “Clean Water Initiative Program Grant Screening.”

¹⁰Note that Act 250 permit amendments may require more extensive review of project impacts to natural resources including wildlife habitat, significant natural communities, and riparian zones. Please consult with the Act 250 District Coordinator regarding the nature and scope of that review and what bearing it may have on your project design.

level (shoreline) of a lake or pond? ¹¹					
If yes , you might need either a Shoreland Protection Act Permit or a Lake Encroachment Permit. Use the Water Quality Project Screening Tool to find the Lakes and Ponds Program contact for your project's region.					
Regulatory Point of Contact Name/Position:					
III. Rivers, River Corridors, and Flood Hazard Areas					
1. Is there any portion of the project site located within 100' of a river corridor and/or mapped Federal Emergency Management Agency (FEMA) flood hazard area¹²? (e.g. a stormwater pond's pipe draining into a river corridor area)? Any permanent excavation/filling or construction within a flood hazard area or river corridor may trigger regulatory requirements through municipal bylaws or through state authorities.	<table> <tr> <td>Yes</td> <td>No</td> </tr> <tr> <td><input checked="" type="radio"/></td> <td><input type="radio"/></td> </tr> </table>	Yes	No	<input checked="" type="radio"/>	<input type="radio"/>
Yes	No				
<input checked="" type="radio"/>	<input type="radio"/>				
If yes , you will need to speak with a Floodplain Manager . Use the Water Quality Project Screening Tool to find the Floodplain Manager for your project's region.					
Regulatory Point of Contact Name/Position:					
Rebecca Pfeiffer, Floodplain Manager					
2. Is any portion of the project site within a perennial river or stream channel? <small>13</small>	<table> <tr> <td>Yes</td> <td>No</td> </tr> <tr> <td><input checked="" type="radio"/></td> <td><input type="radio"/></td> </tr> </table>	Yes	No	<input checked="" type="radio"/>	<input type="radio"/>
Yes	No				
<input checked="" type="radio"/>	<input type="radio"/>				
If yes , you will need to speak with a Stream Alteration Engineer . Use the Water Quality Project Screening Tool to find the Stream Alteration Engineer for your project's region.					
Regulatory Point of Contact Name/Position:					
Chris Brunelle, River Management Engineer					
IV. Wetland					

¹¹ The [ANR Atlas Clean Water Initiative Program Grant Screening tool](#) can help answer this yes/no question. Follow the instructions on the link above to identify whether your project is located in the jurisdictional zone to trigger a Lakeshore permit. Note that the layer to activate in ANR Atlas is now named "Clean Water Initiative Program Grant Screening."

¹² FEMA mapped Flood Hazard Areas are not available statewide on the ANR Natural Resources Atlas. For projects located in Grand Isle, Franklin, Lamoille, Addison, Essex, Orleans, Caledonia, and Orange Counties, maps are available via the FEMA Flood Map Service Center: <https://msc.fema.gov/portal/home>. ANR Floodplain Managers are available to provide technical assistance if needed.

¹³ Stream Alteration Permits regulate all activities that take place within perennial river and stream channels. Examples of regulated activities include streambank stabilization, dam removal, road improvements that encroach on streams, and bridge/culvert construction or repair. The [ANR Atlas Clean Water Initiative Program Grant Screening tool](#) can help answer this yes/no question. Follow the instructions on the link above to identify whether your project is located in the jurisdictional zone to trigger a Stream Alteration permit. Note that the layer to activate in ANR Atlas is now named "Clean Water Initiative Program Grant Screening."

<p>1. Does the Wetland Screening Tool¹⁴ provide a result of wetlands likely, very likely, or present at the project site?</p>	<p style="text-align: center;">Yes No</p> <p style="text-align: center;"><input checked="" type="radio"/> <input type="radio"/></p>
<p>2. Does your project site involve land that is in or near an area that has <u>any</u> of the following characteristics:</p> <ul style="list-style-type: none"> o Water is present – ponds, streams, springs, seeps, water filled depressions, soggy ground under foot, trees with shallow roots or water marks? o Wetland plants, such as cattails, ferns, sphagnum moss, willows, red maple, trees with roots growing along the ground surface, swollen trunk bases, or flat root bases when tipped over? o Wetland Soils – soil is dark over gray, gray/blue/green? Is there presence of rusty/red/dark streaks? Soil smells like rotten eggs, feels greasy, mushy or wet? Water fills holes within a few minutes of digging? (See Landowners Guide to Wetlands for additional information on identifying wetlands onsite.) 	<p style="text-align: center;">Yes <input checked="" type="radio"/></p> <p style="text-align: center;">No <input type="radio"/></p> <p style="text-align: center;">Not Sure <input type="radio"/></p>
<p>If you answered yes or not sure to <u>either</u> of the above questions, you will need to contact your District Wetlands Ecologist using the Wetland Inquiry Form. The District Wetlands Ecologist can help determine the approximate locations of wetlands and whether you need to hire a Wetland Consultant to conduct a wetland delineation. Alternatively, if you answered yes or not sure to <u>either</u> of the above questions, you can simply budget for a Wetland Consultant in the proposed scope of work. Any activity within a Class I or II wetland or wetland buffer zone (minimum of 100 feet and 50 feet respectively) which is not exempt or considered an “allowed use” under the Vermont Wetland Rules requires a permit. All permits must go through review and public notice process, which takes at minimum 6 weeks for a General Permit and 5 months for an Individual Permit.</p> <p>Regulatory Point of Contact Name/Position:</p> <p>Shannon Morrison, District Wetlands Ecologist. No wetlands on site (see project screening map).</p>	
<p>1. Is your project a Wetland Restoration project type?</p>	<p style="text-align: center;">Yes No</p> <p style="text-align: center;"><input type="radio"/> <input checked="" type="radio"/></p>
<p>If you answered yes, under the Vermont Wetland Rules you will need an “allowed use” determination from the DEC Wetlands Program. Contact your District Wetlands Ecologist using the Wetland Inquiry Form.</p> <p>Regulatory Point of Contact Name/Position:</p>	
<p>V. Fish and Wildlife</p>	
<p>State law protects endangered and threatened species. No person may take or possess such species without a Threatened & Endangered Species Takings permit.</p> <p>1. Does your project involve cutting down trees larger than 5 inches in diameter in any of the following towns? Addison, Arlington, Benson, Brandon, Bridport, Bristol, Charlotte, Cornwall, Danby, Dorset, Fair Haven, Ferrisburgh, Hinesburg, Manchester, Middlebury, Monkton, New Haven, Orwell, Panton, Pawlet, Pittsford, Rupert, Salisbury, Sandgate, Shoreham, Starksboro, St. George, Sudbury, Sunderland, Vergennes, Waltham, West Haven, Weybridge, Whiting</p>	<p style="text-align: center;">Yes No</p> <p style="text-align: center;"><input type="radio"/> <input checked="" type="radio"/></p>

¹⁴ To view the Wetland Screening Tool introduction video, see <https://youtu.be/6lv5en0AB1o>

2. Is the project site within 1 mile of a mapped¹⁵ Significant Natural Community or Rare, Threatened, or Endangered Species?	Yes <input checked="" type="radio"/> No <input type="radio"/>
If yes to either of the above questions, connect with the VT Fish and Wildlife department (everett.marshall@vermont.gov 802-371-7333) to discuss your project and any necessary permitting. Regulatory Point of Contact Name/Position: Everett Marshall, Natural Heritage Coordinator (see attachment)	
VI. Stormwater	
1. Will the project disturb more than an acre of land during construction, add or redevelop impervious surface, create new development or otherwise require a Stormwater permit?	Yes <input type="radio"/> No <input checked="" type="radio"/>
If yes , forward to the appropriate Stormwater specialist to ensure necessary permitting. Use the Water Quality Project Screening Tool to find the Stormwater specialist for your project's region. Regulatory Point of Contact Name/Position:	
VII. Solid Waste	
2. Will you be creating any debris (including construction and demolition waste, stumps, brush, untreated wood, concrete, masonry, and mortar) with your project that you intend to bury on site? ¹⁶	Yes <input type="radio"/> No <input checked="" type="radio"/>
If yes, connect with the Waste Management & Prevention Division (dennis.fekert@vermont.gov 802-522-0195) to discuss your project and any necessary permitting. Regulatory Point of Contact Name/Position:	
Provide below or attach a narrative summary of Table 4 findings. Please include: <ol style="list-style-type: none"> Which permits or permit amendment are needed or might be needed? What type might be needed? (e.g. a general or individual permit)? What concerns were voiced by permitting staff? How will the proposed scope of work address these concerns? 	
Is the project, as proposed, reasonably considered permit-able by all applicable	Yes <input checked="" type="radio"/> No <input type="radio"/>

¹⁵ Find both of these layers on the ANR Atlas under Atlas Layers/Fish and Wildlife. Use the Measurement tool to 1) Plot Coordinates for your project 2) select the coordinates from the left panel 3) select the Radius Tool 4) click on your project location 5) Indicate 1 mile distance 6) look for overlap with either of these mapped layers.

¹⁶ If your project will result in the transfer and disposal of debris (including construction and demolition waste, stumps, brush, untreated wood, concrete, masonry and mortar), you do not need a permit from this office as long as you hire a [licensed solid waste hauler](#) and bring the material to a certified facility.

ANR permitting programs? (Answer must be Yes to continue)	
--	--

Step 5: Conduct Eligibility Criteria #5-8 Screenings

Table 5A. Eligibility Criteria 5-8	
Landowner and Operation and Maintenance Responsible Party Support. Project identifies and demonstrates commitment from a qualified and willing operation and maintenance responsible party. Project demonstrates landowner support for the proposed project phase. (Answer must be YES to proceed)	Yes <input checked="" type="radio"/> No <input type="radio"/>
Budget. Project budget includes ineligible expenses. (Answer must be NO to proceed)	Yes <input type="radio"/> No <input checked="" type="radio"/>
Leveraging. Proposed leveraging meets required leveraging levels (if applicable), meets the definition of leveraging, and comes from eligible sources (Answer must be YES or N/A to proceed)	Yes <input type="radio"/> No <input type="radio"/> N/A <input checked="" type="radio"/>
Funding Program Specific Eligibility. Project meets additional funding program eligibility requirements*. Please list applicable funding program below: Lamoille CWSP-Water Quality Restoration Formula Grant (Answer must be YES to proceed) *If Water Quality Restoration Formula Grant, complete Step 6 below	Yes <input checked="" type="radio"/> No <input type="radio"/>

Step 6: Screening Projects on Agricultural Lands (Water Quality Restoration Formula Grants Only)

For Water Quality Restoration Formula Grant projects, please complete the following information as part of your Funding Program Specific Eligibility Screening (Criteria 8). Please note this must be completed for all projects located on agricultural lands regardless of project type. See [CWIP Project Types Table](#) for eligible project types.

Table 6A. Screening Projects on Agricultural Lands	
1. Is the proposed project located on a jurisdictional farm operation ¹⁷ ? Complete a preliminary review to	<input type="radio"/> Yes - Proceed to next question below.

¹⁷ Jurisdictional farm operations are required to meet Vermont’s Required Agricultural Practices (RAPs).

<p>determine if it is a jurisdictional farm operation, and any case that requires consultation with AAFM will occur via the farm determination process. Please note this form must be submitted by the farm operation/landowner seeking the determination.</p>	<p><input checked="" type="radio"/> No¹⁸ - There is no additional requirements related to agricultural review for these projects.</p>
<p>2. Is the proposed project an agricultural project?</p> <p>Examples of agricultural projects include but are not limited to Production Area Practices – (e.g. Waste Storage Facilities, Heavy Use Area, Diversion) Fence, Livestock Exclusion, Filter Strip, Cover Crop, Reduced Tillage, Manure Injection, Rotational Grazing. Please note this is not an exhaustive list of all agricultural practices.</p>	<p><input type="radio"/> Yes - Agricultural Projects on jurisdictional farms are not an eligible project type. You can provide a referral to an applicable state or federal agricultural assistance program, or a local organization.</p> <p><input checked="" type="radio"/> No- The natural resource, innovative, or other project type will require an agricultural project review and approval from the Vermont Agency of Agriculture, Food and Markets (VAAFAM) to ensure a consistent approach on farms statewide that follows rules, regulations, and laws in place. Please follow Steps 1 & 2 below.</p> <p>Step 1- Please submit a detailed description of the project, project site, project details, landowner, farm operation, and any other relevant information to VAAFAM at AGR.WaterQuality@Vermont.gov .</p> <p>Step 2- Once you complete this Agricultural Project Review, please allow 30 days for a response. Once that response has been received, please include a summary of the response in the next section.</p>
<p>Agricultural Project Review Status & Summary:</p>	
<p>Check as Applicable</p>	<p>Status</p>
<p><input type="checkbox"/></p>	<p>Submitted/ Pending</p>
<p><input type="checkbox"/></p>	<p>Approved</p>
<p><input type="checkbox"/></p>	<p>Denied</p>

¹⁸ Note CWIP’s Agricultural Pollution Prevention project type eligibility is limited to land where owner or operator is not a jurisdictional farm (i.e., not required to meet the Required Agricultural Practices (RAPs)). As such, projects that meet the definition of the Agricultural Pollution Prevention project type in the [Appendix B. Project Types Table](#) are not subject to review by VAAFAM.

Hi Megan, the state endangered Cylindrical Papershell (*Anodontooides ferussacianus*) is known immediately downstream of the project area in the vicinity of the bridge. I understand that there will be no in-stream work and this is a stormwater project designed to limit erosion and discharge, and will likely improve the habitat for the freshwater mussel. We do not anticipate any impacts to the endangered species assuming suitable erosion control structures and measures are in place during construction.

I have copied our Zoologist Mark Ferguson for his information.



Everett Marshall (he/him)
Information Mgr./Natural Heritage Coord.
Vermont Fish and Wildlife Dept.
Vermont Agency of Natural Resources
Davis 2, 1 National Life Dr | Montpelier, VT 05620-3901
802-371-7333 (cell)
<http://anr.vermont.gov/>

From: Eldridge, William <William.Eldridge@vermont.gov>
Sent: Wednesday, June 29, 2022 8:15 AM
To: Wichrowski, Mike <Mike.Wichrowski@vermont.gov>; meghan@lpcvt.org; Marshall, Everett <Everett.Marshall@vermont.gov>
Cc: Jensen-EXT, Seth <seth@lpcvt.org>
Subject: RE: Dorothy Smith Access Area-Project Screening Question-Rare and Protected Species

All,

Adding to what Mike said, this is a stormwater project designed to limit erosion and discharge so it should reduce impacts.



Will Eldridge | Aquatic Habitat Biologist
Vermont Fish and Wildlife Department
3902 Roxbury Road | Roxbury, VT 05669
802-585-4499 cell
<https://vtfishandwildlife.com/vthabitatstamp>

Due to the coronavirus (COVID-19), the Agency of Natural Resources is taking additional safety measures to protect our employees, partners and customers. We are now working remotely and focused on keeping our normal business processes fully functional. We encourage you to communicate electronically or via phone to the greatest extent possible. Thank you for your patience and understanding that responses may occasionally be delayed.

From: Wichrowski, Mike <Mike.Wichrowski@vermont.gov>
Sent: Wednesday, June 29, 2022 7:35 AM
To: meghan@lpcvt.org; Marshall, Everett <Everett.Marshall@vermont.gov>

Cc: Jensen-EXT, Seth <seth@lpcvt.org>; Eldridge, William <William.Eldridge@vermont.gov>
Subject: RE: Dorothy Smith Access Area-Project Screening Question-Rare and Protected Species

All

The element occurrence that Meghan referenced is the cylindrical papershell mussel. Since we will not be doing any in-water work, there should not be any impact to this species.

Mike

Mike Wichrowski | Lands & Facilities Administrator (He/Him)
Vermont Department of Fish & Wildlife
Fisheries Division
Davis 2 | 1 National Life Dr | Montpelier, VT 05620-3901
802-917-1347

Due to the coronavirus outbreak, ANR is taking what safety measures we can to help slow the spread. I will be dividing time between in-office and telework days and many staff are working remotely. Our focus remains on keeping normal business processes fully functional. Please communicate electronically or via phone to the greatest extent possible. Thank you for patience and understanding as responses may occasionally be delayed.

From: Meghan Rodier <meghan@lpcvt.org>
Sent: Tuesday, June 28, 2022 2:13 PM
To: Marshall, Everett <Everett.Marshall@vermont.gov>
Cc: Jensen-EXT, Seth <seth@lpcvt.org>; Eldridge, William <William.Eldridge@vermont.gov>;
Wichrowski, Mike <Mike.Wichrowski@vermont.gov>
Subject: Dorothy Smith Access Area-Project Screening Question-Rare and Protected Species

EXTERNAL SENDER: Do not open attachments or click on links unless you recognize and trust the sender.

Dear Everett Marshall,

While conducting project screening for a Block Grant application to apply for Final Design for a floodplain/riparian habitat restoration project at the Dorothy Smith Access Area, I noticed rare and protected species are mapped south of the site. While this is mapped off the proposed project site, I am reaching out to see if there are special design considerations or permit needs based on this finding that will need to be considered in the Final Design phase. For reference, please find attached a screen shot of the area I am referring to and the proposed design plans for the floodplain restoration project.

Thank you for your time.

Best Regards,

Meghan Rodier
Regional Planner
Lamoille County Planning Commission

Wetlands Inventory Map Screen Shot

VERMONT Wetlands Inventory Map
Vermont Agency of Natural Resources

Map Tools | Navigation | Map Data | Draw | Identify | Query | Select | Measurement | Edit Features

Sign In | Open | Save | Share | Export | Print | Contact Us

Layers

- WetlandsTheme
- Filter Layers...
 - Wetland
 - Wetland Map
 - Wetland Projects
 - Watershed Protection
 - Fish and Wildlife
 - Geology
 - Drinking and Groundwater Protection
 - Parcels
 - Parcels (standardized)
 - E911 Buildings
 - E911 Buildings
 - ANR Basemap Data
 - Color Imagery by Year
 - Vermont Orthophotos
- Imagery Layers

Quick Tools... 44.65127, -72.82851

RARE AND PROTECTED SPECIES

- RARE AND PROTECTED SPECIES

Element Occurrence ID: 8053
State Protection: State-Endangered
Federal Protection:

[View Additional Details](#) [Add to Results](#)

Map features include: Dorothy Smith Access (0.13 mi), 2021-197, 2016-465, 1992-552, 247 BLACKBERRY HILL, DR, 234 BLACKBERRY HILL, DR, 897 VY ROUTE 108, 108, 15, 20, 40m, 150ft, Bing Basemap, and a scale bar.

VT ANR Atlas Screen Shot

VERMONT Natural Resources Atlas
Vermont Agency of Natural Resources

Layers: Atlas Layers, Filter Layers... (Filter)

- Trail Corridor
- Rare Threatened Endangered Species
- Significant Natural Community
- Uncommon Species and Other
- Features
 - Deer Wintering Areas
 - Brook Trout Waters
 - Habitat Blocks
 - State Game Refuges
 - Natural Communities on ANR
- Lands
 - Managed Lands
 - Indiana Bat Hibernacula
 - Indiana Bat Summer Range
 - Wildlife Management Units
 - Vermont Waterfowl Hunting Zones
- Baitfish Zones

Quick Tools... 44.65127, -72.82851 4 of 5

Rare, Threatened and Endang...
★ Rare, Threatened and Endangered Species
Element Occurrence ID: 8053
State Protection: Y
Federal Protection:
Update Date is 2021/06/17
[Link to Element Occurrence \(EO\) Report](#)
[View Additional Details](#) [Add to Results](#)

Dorothy Smith Access Parking Lot
Boat Access
Dorothy Smith

ESRI Wor... 0 50 100m 15000

FFI Functioning Floodplain Initiative

HOME EXPLORE DATA PROJECT PLANNING WATERSHED REPORTING USER MANUAL

PROJECT SCREENING

River Corridor ID	Floodplain (Lat-Vert) Connectivity (Score of 0-100)	Total Feasibility (Score of 0-100)	TP Load Assigned to Floodplains (t/g)	Incision Ratio	Existing Inundation Vulnerability	Existing Erosion Vulnerability	Habitat Priority	Number of Priority Projects	Add to Project Calculations
▶ 16_R08-7_C00	32.6	39.4	3.8	1.3	Moderate-High	Moderate-High	-	3	<input checked="" type="checkbox"/>
▶ 16_R09-1_C00	33.2	47.4	2.5	1.8	High	Moderate-Low	-	5	<input checked="" type="checkbox"/>

EXPORT CSV EXPAND ALL CLEAR RESULTS

Hi Meghan and Tori,

I measured the project area in the CAD and got 0.9 acres of area that the project would either be lowering or revegetating or both. I think the 1.0 acre analysis that you did is closer than the 1.5 acre. I did a test and attached my results here.

I did add in the stability credit associated with the project, which I believe you can count due to the improved vertical connection to the floodplain. It is not a very big credit, but does add some.

Jessica Clark Louisos MS, PE
Principal Water Resources Engineer

O 802-882-8335

M 802-578-2016

E ilouisos@slrconsulting.com

SLR International Corporation

1 South Main Street, 2nd Floor, Waterbury, VT, United States 05676

Browser address bar: <https://ffistone-env.net/explore-data>

Navigation: HOME EXPLORE DATA PROJECT PLANNING WATERSHED REPORTING USER MANUAL

FFI Functioning Floodplain Initiative

EXPORT CSV CLEAR RESULTS CALCULATE

Enter Proposed Information for Potential Stream Stability Projects Below:

▼ Floodplain Connectivity (Lateral-Vertical) and Storage Crediting

Proposed River Corridor and Floodplain Projects:

- Restore Channel Slope
- Plant Floodplain
- Plant River Corridor
- Reconnect Flood Chute
- NRCS Wetland Reserve
- Restore Channel Roughness and Wood
- Remove Minor Constraint
- Adopt River Corridor Bylaws
- Create Flood Bench
- Plant 50-Foot Riparian Area
- Raise Channel
- Remove Berm
- Restore Wetland
- Remove Major Constraint
- Implement River Corridor Easement
- Lower Floodplain

STREAM STABILITY (FLOODPLAINS)

STORAGE

River Corridor ID	Existing River Corridor Area (acres)	50-ft Riparian Area (acres)	Existing Incision Ratio	Unconstrained River Corridor Area (acres)	Robust Protection Area (acres)	Moderate Protection Area (acres)	Low Protections Area (acres)	No Protection Area (acres)	Naturally Vegetated Buffer Area (acres)	Proposed Incision Ratio	Area with Vertical Change (acres)
16_R08- _7_C00	Existing 19.1	4.0	1.3	6.5	0	14.0	4.8	0.2	2.3	-	-
Proposed Project Values											
									7	1.2	7
16_R09- _1_C00	Existing 12.8	3.1	1.8	8.8	0	9.5	3.1	0.2	2.0	-	-
Proposed Project Values											
									2	1.2	2

EXPORT CSV CLEAR RESULTS

CALCULATE

Enter Proposed Information for Potential Stream Stability Projects Below:

▼ Floodplain Connectivity (Lateral-Vertical) and Storage Crediting

Proposed River Corridor and Floodplain Projects:

- | | | |
|---|---|--|
| <ul style="list-style-type: none"> <input type="checkbox"/> Restore Channel Slope <input checked="" type="checkbox"/> Plant Floodplain <input type="checkbox"/> Plant River Corridor <input type="checkbox"/> Reconnect Flood Chute <input type="checkbox"/> NRCS Wetland Reserve <input type="checkbox"/> Restore Channel Roughness and Wood | <ul style="list-style-type: none"> <input type="checkbox"/> Remove Minor Constraint <input type="checkbox"/> Adopt River Corridor Bylaws <input type="checkbox"/> Create Flood Bench <input type="checkbox"/> Plant 50-Foot Riparian Area <input type="checkbox"/> Raise Channel | <ul style="list-style-type: none"> <input type="checkbox"/> Remove Berm <input type="checkbox"/> Restore Wetland <input type="checkbox"/> Remove Major Constraint <input type="checkbox"/> Implement River Corridor Easement <input checked="" type="checkbox"/> Lower Floodplain |
|---|---|--|

River Corridor ID	STREAM STABILITY (FLOODPLAINS)		Project Area Connectivity		STORAGE	
	Existing	Proposed Project Values	Existing Reach Connectivity	Project Area Connectivity	Existing	Proposed Project Area (acres)
16_R08-7_C00	Existing	Low	Low	Medium	-	7
16_R09-1_C00	Existing	Low	Low	Medium	-	2

► Stream Connectivity (Longitudinal-Temporal) Crediting

EXPORT CSV

Estimated Phosphorus Credit for Stream Stability and Storage

SubUnit(s) IDs: 16_R08-_7_C00, 16_R09-_1_C00
 Town: CAMBRIDGE
 Projects Included: Plant Floodplain, Lower Floodplain
 Stream Names: -
 Project Area (acres): 0.8999999999999999
 Stream Stability and Storage Credit Summary

	Year 1 Credit (kg)	Year 2+ Credit (kg/yr)	Estimated 15 Yr Lifespan Credit (kg)
Floodplain Connectivity (Lateral - Vertical)			
Stream Stability	0.1	0.1	1.5
Storage	6.2	2.8	46.2
Stream Connectivity (Longitudinal - Temporal)			
Stream Stability	0.0	0.0	0.0
TOTAL	6.3	2.9	47.7

Stream Stability Credit and Connectivity Details

Floodplain and Stream Restoration Estimated Phosphorus Reduction Calculator

kg of TP = Stream Stability P Reduction + Storage P Reduction
 Stream Stability P Reduction = project type and basin P reduction factor (lb/acre/yr) * acres * kg per lb
 Storage P Reduction = pre- to post- restoration change in connectivity factor (lb/acre/yr) * acres * kg per lb * 50% after year 1

Variable	Value	Unit
Unit conversion	0.454	lb to kg
Consecutive year storage p reduction	50%	of year 1

Notes:
 Not all floodplain and stream restoration projects receive a storage p reduction credit. If a project does not effectively change the ability of a stream or river to access a floodplain, select matching floodplain connectivity ranking for pre- and post- restoration (ex: floodplain connectivity pre-restoration = low, floodplain connectivity post-restoration = low). For more detail on phosphorus credit allocations by project type, please refer to the Standard Operating Procedures for Tracking & Accounting of Natural Resources Restoration Projects available on the VT DEC website.

The Functioning Floodplains Initiative (FFI) web application (coming soon) is equipped to generate the most accurate estimation of phosphorus reduction achieved through a floodplain or stream restoration project based on more detailed project specifications, and will ultimately be used for phosphorus accounting purposes by VT DEC. This tool was developed as an interim solution to provide high level estimation of potential phosphorus reductions and can be used to help compare potential project outcomes to inform prioritization. Phosphorus reductions calculated in the interim tool are based on PF project simulations by project type and watershed. This interim tool cannot be used to accurately account for stacked practices (i.e. multiple project types implemented in a single location) however, the PF tool will allow for calculation of estimated phosphorus reduction resulting from implementation of multiple project components, such as a river corridor easement layered on a floodplain restoration and buffer planting.

Input*	Dropdown*	Dropdown*	Input Value*	Dropdown*	Dropdown*	Output value	Output value	Output value	Output value	Output value	
Project Identifier	Basin	Project Type	Acres Restored	Number of Culverts Replaced (if applicable)	Floodplain Connectivity Pre-Restoration	Floodplain Connectivity Post-Restoration	Stream Stability P reduction (lb/yr)	Year 1 Storage P Reduction (lb)	Consecutive Year Storage P Reduction (lb/yr)	Estimated Year 1 P Reduction (kg)	Estimated Annual P Reduction After Year 1 (kg/yr)
Dorothy Smith Access Area	Lamoille	Floodplain Restoration with Buffer Revegetation	1.00	0.00	Low	Moderate	0.40	15.00	7.50	6.99	3.58

SubUnit(s) IDs: 16_R08-6_C00, 16_R08-7_C00

Town: CAMBRIDGE

Projects Included: Plant Floodplain, Lower Floodplain

Stream Names: -

Project Area (acres): 1

Stream Stability and Storage Credit Summary

	Year 1 Credit (kg)	Year 2+ Credit (kg/yr)	Estimated 15 Yr Lifespan Credit (kg)
Floodplain Connectivity (Lateral - Vertical)			
Stream Stability	0.0	0.0	0.0
Storage	6.8	3.2	51.4
Stream Connectivity (Longitudinal - Temporal)			
Stream Stability	0.0	0.0	0.0
TOTAL	6.8	3.2	51.4

▶ Stream Stability Credit and Connectivity Details

PROJECT BUDGET SUMMARY			
a. <i>BUDGET TABLE</i> : Estimates are acceptable. See attached cost estimate from SLR and LCPC estimated hours for project management.			
Expense/Item	Formula Restoration Grant Request	Leverage / Match Funds	TOTAL
APPLICANT	\$219,265	0.00	\$219,265
Project Management/Completion: staff expenses including salary and fringe benefits (all deliverables documentation and reporting tasks should be included) This is time budgeted for the LCPC to help VFWD manage the project and grant. VFWD will contract with the LCPC for these services. LCPC is pre-qualified under the Basin 7 CWSP.	\$7,065		\$7,065
Volunteers or ad hoc employees			
Mileage Charges (use applicable Federal rate) (Mileage included in LCPC project management costs above)			
Supplies / Materials not purchased by contractors			
Equipment Rentals or Equipment Use charges			
SUBCONTRACTORS			
Pre-design consultations, site visits, etc.			
Engineering/Design Services for 30% Design or Final Design			
Bid Management/Construction Oversight Services	\$32,500		\$32,500
Construction Services (includes 15% construction contingency)	\$169,500		\$169,500
Post Monitoring/O and M cost for first 3 years	\$10,200		\$10,200
<i>Project Completion</i> SUBTOTAL			
Indirect**: If you have a negotiated indirect rate, you typically charge, please use that. Otherwise, you may charge 10% on staff expenses. (LCPC staff time and indirect rate included in project/grant management cost noted above. See attached LCPC Indirect Rate Approval Letter.)			
<i>Project Completion</i> TOTAL (<i>Project Completion</i> SUBTOTAL + Indirect)	\$219,265	0.00	\$219,265
Procurement of subcontractors: Subcontractors such as engineers/designers and construction services must be competitively procured.			

Estimated Project Management Cost

rev 9-8-2021

Lamoille County Planning Commission

Dorothy Smith Access Area Floodplain Restoration

Gray cells auto-calculate, do not edit. Enter white cells only.

SUB-GRANT ADMINISTRATION AND PROJECT MANAGEMENT EXPENSES

Personnel (Name, Title)	Tasks/Responsibilities	Hours	Hourly Rate (including Fringe)	Total Salary Expense	Match*	Amount requested
Meghan Rodier, Regional Planner	Meghan will serve as a project/grant manager.	91	\$35.50	\$3,230.50	Do not write in this space.	
		0	\$0.00	\$0.00		
		0	\$0.00	\$0.00		
		0	\$0.00	\$0.00		
Personnel Subtotal				\$3,230.50		
Indirect Costs		Indirect Rate	Cost related to Indirect rate	Total Indirect cost	Match*	Amount Requested
		111.71%	\$3,230.50	\$3,608.79	Do not write in this space	
Indirect Subtotal				\$3,608.79		
Anticipated Travel	Purpose	Miles	Mileage Rate	Total Travel Expense	Match*	Amount Requested
Site Visits/Meetings	Travel to site for pre-construction meetings, during construction check-ins, and post construction final walk through.	322	\$0.67	\$215.74	Do not write in this space.	
		0	\$0.00	\$0.00		
Travel Subtotal				\$215.74		
NA						
Supplies/Other	Description/Use	# of Units	Unit Cost	Total Supplies Expense	Match*	Amount Requested
Printing	Printing cost (printing final design plans for meetings/site visits etc.)	20	\$0.50	\$10.00	Do not write in this space.	
		0	\$0.00	\$0.00		
		0	\$0.00	\$0.00		
Supplies & Other Subtotal				\$10.00		
TOTAL GRANTEE ADMINISTRATION AND PROJECT MANAGEMENT EXPENSES				\$7,065.03		\$7,065.03



State of Vermont
Agency of Transportation
Finance & Administration Division
Audit Section
219 North Main Street
Barre, VT 05641

May 28, 2024

Tasha Wallis, Executive Director
Lamoille County Planning Commission
PO Box 1637
Morrisville, VT 05661

Subject: Regarding Indirect Cost Recovery Rate for FY25

Dear Ms. Wallis:

As you know, your regional planning commission (RPC) is a political subdivision of the state, considered a local government whose indirect rate proposal must be prepared in compliance with 2 CFR Part 200. Vermont Agency of Transportation Memorandum of Understanding MU0378, agreement executed July 1, 2023, details the conditions for preparation, submittal, and approval of RPC indirect cost rates.

I have reviewed your proposed indirect cost rate of **111.71%** for July 1, 2024 through June 30, 2025 based on Lamoille County Planning Commission's audited costs for FY2023. You have certified to us, as required in the MOU, the inputs and calculations used to arrive at this rate are to the best of your knowledge compliant, accurate, and true. Based upon our review and your certification, we accept this rate for conducting business with the Vermont Agency of Transportation. Please note that we may adjust this rate if we obtain additional information that warrants it. We reserve the right to audit this rate or seek further information from the independent auditors pertaining to the procedures they performed.

We look forward to continuing to work with you and your colleagues at Lamoille County Planning Commission.

Sincerely,

DocuSigned by:

Kara Mayo

F398B30743C545B...
Kara Mayo

AOT Audit Specialist II
kara.j.mayo@vermont.gov

copy: Nicole Sancibrian, CPA PLLC



BALLPARK OPINION OF PROBABLE CONSTRUCTION COSTS
Dorothy Smith Access Area Floodplain Restoration
Jeffersonville, Vermont
November 11, 2024
SLR # 12911.00021



Description	Unit	Quantity	Unit Price (\$)	Amount (\$)
SITE PREPARATION				
MOBILIZATION	LS	1	10,000	10,000
CONSTRUCTION ENTRANCE	CY	20	55	1,100
SILT FENCE	LF	300	7	2,100
SEDIMENT AND EROSION CONTROLS	LS	1	4,000	4,000
TEMPORARY CONSTRUCTION FENCING	LF	300	3.0	900
CONSTRUCTION STAKING/SURVEY	LS	1	2,000	2,000
STORMWATER IMPROVEMENTS				
REMOVE STRUCTURE AND SIGNS	LS	1	2,000	2,000
CRUSHED STONE	CY	20	50	1,000
REMOVE GRAVEL AND PAVEMENT	CY	500	30	15,000
HAUL EXCESS MATERIALS OFFSITE	CY	500	20	10,000
TOPSOIL AND FINAL GRADING	CY	100	65	6,500
PARKING GRAVEL TOP COAT	CY	50	60	3,000
CONSTRUCT NEW ENTRANCE	LS	1	5,000	5,000
FLOODPLAIN RESTORATION				
EXCAVATION AT FLOODPLAIN AND HAUL	CY	600	25	15,000
TOPSOIL AND FINAL GRADING	CY	100	50	5,000
ACCESS				
PATH RESTORATION	LS	1	2,000	2,000
BANK STABILIZATION	CY	80	65	5,200
STONE STEPS	LS	1	2,000	2,000
RESTORATION OF SITE				
SIGNAGE	LS	1	2,500	2,500
DELINEATOR STAKES	EA	35	20	700
BOULDER BARRIER	EA	18	250	4,500
RESTORATION OF ACCESS & STAGING	LS	1	2,000	2,000
SEED AND MULCH	LS	1	3,000	3,000
TOPSOIL AND FINAL GRADING	CY	200	65	13,000
TREES, BALL & BURLAP	EA	25	400	10,000
RIPARIAN TREES AND VEGETATION	LS	1	20,000	20,000
CONSTRUCTION SUBTOTAL				\$ 147,500
BID MANAGEMENT				\$ 3,500
CONSTRUCTION OVERSIGHT AND DOCUMENTATION (PART-TIME)				\$ 29,000
POST-CONSTRUCTION MONITORING (3 YEARS)				\$ 10,200
CONSTRUCTION CONTINGENCY (15%)				\$ 22,000
TOTAL				\$ 212,200

Funding for permit phase was covered under the existing DIBG LCPC holds which covered the Final Design Phase.



Dorothy Smith Access Area

Vermont Agency of Natural Resources

vermont.gov



LEGEND

- Wetland - VSWI
 - Class 1 Wetland
 - Class 2 Wetland
 - Wetland Buffer
- Wetlands Advisory Layer
- River Main Stem Waterbodies
- WBID Watersheds
- River Corridors (Aug 27, 2019)
 - .5 - 2 sqmi.
 - .25 - .5 sqmi.
- DFIRM Flood Hazard Areas (C FEMA-digitized data)
 - AE (1-percent annual chance flood)
 - A (1-percent annual chance floodpl)
 - AO (1-percent annual chance zone feet)
 - 0.2-percent annual chance flood ha
- Soils - Hydric
- Parcels (standardized)
- ACT250 Permits
- Town Boundary

NOTES

Map created using ANR's Natural Resources Atlas



1: 3,709
October 30, 2024

188.0 0 94.00 188.0 Meters

1" = 309 Ft. 1cm = 37 Meters

THIS MAP IS NOT TO BE USED FOR NAVIGATION

DISCLAIMER: This map is for general reference only. Data layers that appear on this map may or may not be accurate, current, or otherwise reliable. ANR and the State of Vermont make no representations of any kind, including but not limited to, the warranties of merchantability, or fitness for a particular use, nor are any such warranties to be implied with respect to the data on this map.

© Vermont Agency of Natural Resources

Project Schedule
Dorothy Smith Access Area Floodplain Restoration Project- Implementation

Please see below a proposed project schedule for the implementation phase based on anticipated milestones. This schedule is subject to change based on when this project receives funding for implementation.

Milestone	Milestone Completion Timeline
Permits Filed	Filed in November, 2024
Required permits secured	February 1 st , 2025
Project initiated; RFB issued	February 15 th , 2025
Contractor selected	April 1 st , 2025
Pre-Construction Meeting	June 30, 2025
Floodplain Restoration project implemented (construction phase)	October 1 st , 2025
Final Reporting Submitted	December 1 st , 2025

Fish & Wildlife Department
1 National Life Drive
Montpelier, Vermont 05620-3702
www.VtFishandWildlife.com

[phone] 802-241-3700
[fax] 802-828-1250
[tdd] 802-828-3345

Agency Of Natural Resources

December 5, 2023

RE: Final design for Dorothy Smith Access Area

To whom it may concern,

The Vermont Fish & Wildlife Department (Department) supports the stormwater redesign and floodplain restoration project at the Dorothy Smith Access Area in Jeffersonville. The Department is committed to working with the Lamoille County Regional Planning Commission to completing the design and implementing the project. A continued partnership in the Lamoille watershed between LCPC and the Department is critical to meeting Lake Champlain's TMDL requirements and improving water quality throughout the watershed.

Sincerely,

Mike Wichrowski

Mike Wichrowski
Fish & Wildlife Lands & Facilities Administrator



Installing and Maintaining your Clean Water Project

Dear Vermont Fish and Wildlife Department [*landowner's name*],
Thank you for partnering with us to host a voluntary clean water project on your property. This project is intended to protect the quality of Vermont's rivers, lakes, streams, and wetlands. Your participation is a valuable contribution to Vermont's water quality goals. This cover letter provides an overview of the attached Site Access License and Operation and Maintenance Plan and highlights some key aspects of how we will work together to help the project succeed. **Please read the attached Agreement carefully for the complete agreement terms.**

What is this agreement saying?

Introduction and Project Description

Page one into page two describes the agreement start date, the parties to the agreement and their contact information as well as project details including location and expected "design life" (the number of years we expect that the project will protect water quality).

The Project Description provides the type of project and the expected maintenance activities, and frequency of those activities needed in order to keep the project in good condition.

Terms of Agreement

After the project description topics, the document lists the terms of the Agreement—what the parties agree to, how long you're agreeing to it, and other expectations for both parties.

The Agreement allows the Lamoille Clean Water Service Provider (NRPC staff) and staff from the Vermont Department of Environmental Conservation to access the project on your property for planned visits with necessary equipment for the following purposes: 1) to install the project, 2) to regularly inspect the project to ensure proper function, and 3) to conduct routine maintenance activities that include as needed re-seeding conservation wildlife mix, re-planting bare root trees, mowing near the footpath to the boat access area, and monitoring the restored floodplain for erosion and scouring, to keep the project working properly. We may also request to visit your property if damage is suspected (such as after a large storm) to inspect and possibly perform repairs. If you have concerns about damage to a project or if there is something you feel is not working properly, please contact us to request a site visit. All visits will be scheduled by the Vermont Fish and Wildlife Department Lands & Facilities Administrator, Mike Wichrowski via phone or email [Mike.Wichrowski@vermont.gov or 802-917-1347] with at least 48 hours' notice. Refer to the Operation and Maintenance Plan in the Agreement for more details.

Agreement Duration

The Site Access **License** Agreement will last for 10 years. You or the Clean Water Service Provider (CWSP) can choose to cancel this agreement at any time following certain notice requirements. If you have concerns, the agreement requires you to inform the CWSP of these concerns at least 60 days before sending a termination notice. You can send the notice of concerns through your landowner liaison if preferred. The CWSP will work to address concerns where feasible. If you still wish to cancel, you can do so by sending written notice by Certified or Registered US Mail. This Site Access License Agreement will end within 180 days after the termination notice is sent.

If you decide to transfer the property, please communicate this landowner change to the Lamoille Basin 7 [CWSP] at least 30 days before the transfer and inform the new landowner about the clean water project and the terms of this site access agreement. In the event that the Department of Environmental Conservation re-assigns the CWSP role to a different entity, you will be notified.

A note about maintenance activities

We share a common goal of taking care of the land to ensure the project's success. As part of this agreement, Vermont Fish and Wildlife will perform or hire out the routine maintenance activities referenced in the O and M Plan listed below. We will implement the maintenance activities outlined in the Operation and Maintenance Plan and will minimize or restore (as reasonably practicable) any impacts that accessing the project site has on the rest of your property.

If you have any questions or concerns about site visits, maintenance activities, or the project itself, please contact Vermont Fish and Wildlife Department [landowner liaison organization] and we will work with you. We appreciate your willingness to be a good steward of your property and working with us to carry out this project. This voluntary project on your land will help us all work towards clean water and healthy watersheds in Vermont. Thank you!

Please indicate a single entity who will serve as the landowner liaison. This organization will communicate with the landowner to schedule verification and maintenance site visits, and address landowner's concerns and questions.

Landowner Liaison Organization: Vermont Fish and Wildlife Department
Contact Person: Mike Wichrowski
Phone: 802-917-1347 Email: Mike.Wichrowski@vermont.gov

Clean Water Project Location: 437-281 Vermont Route 108, Jeffersonville, VT 05464
Landowner Name: Vermont Fish and Wildlife Department
Indicate preferred contact method: Phone: 802-917-1347
Email: Mike.Wichrowski@vermont.gov (preferred)

Clean Water Service Provider: Lamoille Clean Water Service Provider Basin 7

Vermont Department of Environmental Conservation Clean Water Initiative Program
Form Version 2 Updated: 10/28/2024 9:18:00 AM
Project WPD ID:

(Northwest Regional Planning Commission)

Contact Person for Clean Water Service Provider: Dean Pierce

Phone: 802.582.3087 Email: dpierce@nrpcvt.com

SITE ACCESS LICENSE AGREEMENT
FOR A CLEAN WATER PROJECT

- 1. Site Access License Start Date:** January 1, 2025
- 2. Parties and Contact Information.** The Landowner and Clean Water Service Provider (the Parties) and their contact information are:

Landowner:

Landowner Name	<u>Vermont Fish and Wildlife Department</u>
Landowner Phone:	<u>(802)-917-1347</u>
Landowner Email:	<u>Mike.Wichrowski@vermont.gov</u>
Landowner Mailing Address	1 National Life Drive, Davis 2, Montpelier VT, 05620

[Add Additional Landowner tables if needed]

Clean Water Service Provider (CWSP):

CWSP	<u>Lamoille Clean Water Service Provider Basin 7 (Northwest Regional Planning Commission)</u>
CWSP Phone:	<u>(802) 582-3087</u>
CWSP Email:	<u>dpierce@nrpcvt.com</u>
CWSP Mailing Address	75 Fairfield Street, St. Albans, VT 05478

Parties shall provide updated contact information in writing, communicated to all other parties, for communication regarding this Agreement.

- 3. Project Location.** The Project is located at: 437-281 Vermont Route 108, Jeffersonville, VT 05464 (the Property).
Refer to Exhibit B: As-built plan or final site plan with details of what was installed/constructed.

Project Latitude Longitude (center point in Decimal Degrees):	44.65127 ⁰ N , -72.82851 ⁰ W
---	--

- 4. Project Description.** The Project and operation and maintenance will consist of the following:

Project Type:	Floodplain/Stream Restoration
Practice Type:	River or Floodplain Restoration
Watershed Projects Database ID:	12281
Project Title:	Dorothy Smith Access Area Floodplain Restoration
Project Implementation Completion Date:	TBD when funding is secured. Tentative date: October 1, 2025

Project Design Life *:	N/A
Special Equipment Required, if any*: (e.g., Vactor truck, anything other than hand tools)	Hand tools for plantings, mower for mowing near footpath as needed, grader to reslope parking area

[Add additional project description table if multiple practices]

Operation and Maintenance (O&M) Plan	
Operation and maintenance will include the following activities (such as weeding, mowing, sediment and debris removal, inlet and/or outlet cleaning, and equipment maintenance) and project repairs on an as-needed basis within the reasonable discretion of the CWSP*.	Frequency (e.g., quarterly, annually, or as needed)
O/M maintenance for this Vermont Fish and Wildlife Department owned site will include as needed re-seeding New England Conservation Wildlife Mix (grass seed), re-planting bare root trees, mowing near the footpath to the boat access area, occasional regrading of parking to drain to vegetated filter strips, and monitoring the restored floodplain for erosion and scouring.	The site will be monitored annually and after flooding events to evaluate the site for as needed maintenance activities.

*The DEC O&M manual contains guidance on equipment required, frequency of inspections, and O&M activities.

5. **Grant of Site Access License.** Landowner grants the CWSP and its agents, contractors, successors, and assigns, a license and the right to access the Property, with workers and equipment, for undertaking the Project and all reasonably related activities, including operation, maintenance, repair, and replacement. This grant also allows Property access by a duly authorized representative of the Vermont Department of Environmental Conservation (DEC) following 48 hours' notice to Landowner at the last phone number and email provided to the CWSP.
6. **License Period:** __01/1/25__ to __01/1/2035__ (__10__ years, consistent with the Project Design Life (Initial Term), unless terminated earlier by either party). This license will terminate within 180 days after either party sends written notice by Certified or Registered US Mail, with or without cause.

At least 60 days prior to any written notice of termination by the Landowner, the Landowner will inform the CWSP in writing of any reasonable concerns regarding the site access and the CWSP will attempt to reconcile or reasonably respond to landowner's concerns within 60 days.

After the Initial Term, the license will automatically renew for successive 10 year terms, until terminated within 180 days after either party sends written notice by Certified or Registered US Mail, with or without cause.

7. **Notice of Property Conveyance or CWSP Role.** Landowner will inform the CWSP in writing 30 days prior to conveying the Property to a subsequent owner. Landowner will be notified if a different entity is assigned to the CWSP role.
8. **Landowner Use Limitation in Project Area.** This license is not exclusive. The Landowner shall have the right to use, or allow others to use, any part of the licensed Property provided that such use does not interfere with the installation and maintenance of the Project. Landowner will not undertake any activity or make any modifications that materially change the final Project design or intended usefulness without obtaining prior written CWSP approval.
9. **CWSP Restoration of Property Disturbance Outside Project Area; Project Area Release.** The CWSP or its agents, contractors, successors, or assigns, will restore any portion of the Property outside the Project Area disturbed or affected by the exercise of their access rights as near as reasonably practicable to the condition prior to such exercise at the sole cost of the CWSP or its agents, contractors, successors, or assigns and within a reasonable time. Landowner releases CWSP from any obligation to restore the Project Area or reclaim any changes to the Property contemplated within the Project Description.

The Parties have caused this Agreement to be executed as of the date of final signature below.

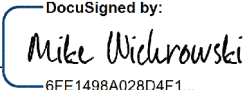
Party Name:  10/28/2024
Date

- [Exhibit A – Access description]
- [Exhibit B – Site plan with details of Project Area]
- [Exhibit C – Supplemental provisions following [Guidance Chapter 7](#), if applicable]

Vermont Division for Historic Preservation
Project Review Form

This form is to be used for both the Preliminary and Final Project Review for clean water projects funded by the Department of Environmental Conservation (DEC) Clean Water Initiative Program (CWIP). See applicable sections below.

Preliminary Project Review Section

To start the VDHP review process for CWIP-funded Clean Water Projects, please complete this form and submit it to the Vermont Division for Historic Preservation (VDHP) at ACCD.projectreview@vermont.gov with the information requested below. This Preliminary Project Review form, once completed and signed by VDHP, should be submitted as a project deliverable.

This is for non-exempt CWIP project types or conditionally exempt that have failed to meet the project qualifications. Exempt project types should NOT submit this form. Please refer to the CWIP Funding Policy for a listing of exempt and conditionally exempt project types. The CWIP Funding Policy can be found here: <https://dec.vermont.gov/water-investment/cwi/grants#policy>

For questions on architectural resources, archaeology, and below-ground resources, please contact Scott Dillon at (802) 272-7358 or scott.dillon@vermont.gov.

1. **Contact information:**

- a. Contact name: Meghan Rodier
- b. Email address: meghan@lpcvt.org
- c. Phone number: 802-888-4548 ext. 103

2. **WPD Project Title:** Dorothy Smith Access Area Floodplain Restoration - Jefferson 

3. **WPD – ID:** 10937

4. **Project site map:** Please attach a project site map. An annotated Google map or [ANR Atlas](#) map will suffice but professional design plans are also welcome. An example image is provided below. Site map should outline:

- a. Project Area of Potential Effects¹ with clearly marked GPS coordinates for project boundaries.

¹ The project APE or “area of potential effects” means the geographic area or areas within which an undertaking may directly or indirectly cause alterations in the character or use of historic properties, if any such properties exist. The

§106 Project Review Form

For Clean Water Projects funded by the DEC Clean Water Initiative Program

- b. Proposed ground disturbance locations. Note that stream bank regrading is considered ground disturbance.

Ground disturbance



5. Project information:

- a. Select CWIP project type from drop down (if not listed, it's categorically exempt)
 - i. Floodplain/Stream Restoration - Final Engineering Design

- a. Please provide a short description of the project's proposed scope of work (CWIP Preliminary Design Report is acceptable instead)

This project will restore riparian habitat and floodplain access at the Dorothy Smith Access Area by reducing impervious surface along the parking lot, removing gravel built up on the floodplain, re-vegetating the floodplain, and maintaining river access via

- b. Are there other Agencies or funding partners involved?: Yes No

- i. If yes, who? DIBG is funding the Final Design. LCPC is working closely on this with VFWP

- c. Does the project involves ground disturbance?: Yes No

- i. If yes, please describe type and extent of ground disturbance.

Specifically,

1. Whether disturbance will be performed by hand or heavy machinery,
2. The estimated total acreage and maximum depth of disturbance, and

APE is influenced by the scale and nature of an undertaking and may be different from different kinds of effects caused by the undertaking [36 C.F.R. § 800.16(d)]. When determining a project's APE remember to consider/include extent of restoration footprint; new, upgraded or existing access or haul roads; staging, storage, and stockpile areas; disposal sites or waste areas; borrow areas and other source locations for fill material; and areas impacted by drainage diversions or mechanical tree clearing and similar landscape alterations.

§106 Project Review Form

For Clean Water Projects funded by the DEC Clean Water Initiative Program

- 3. The history of prior naturally-caused or man-made ground disturbance to the site (if known):

See 100% design plans and memo for site conditions.

- d. Will the project cause direct or indirect impact or disturbance to any man-made building or structure more than 50 years old (including dams, culverts, and bridges) or to any federally listed historic building or structure?

Yes No Unknown

- i. If yes or unknown, provide any known details on the buildings or structure(s) location/condition and extent of proposed impact or disturbance. Please include whether the structure is listed in the National Register of Historic Places if known:

- e. Is the project APE located within, intersect with, or adjacent to a state- or federally listed historic district, Designated Downtown or Village Center?

Yes No Unknown

Email this form and supporting materials to ACCD.ProjectReview@vermont.gov

Please copy scott.dillon@vermont.gov

TO BE COMPLETED BY VDHP:

Historic Properties/Sites Affected

Potential for Architectural Historic Properties to be affected – A Qualified Architectural Historian or Historian Consultant* is required (*please see [pre-approved list of consultants](#))

Determination of Eligibility required

Comments:

Potential for Archaeological Historic Properties to be affected – a Qualified Archaeological Consultant* is required (*please see [pre-approved list of consultants](#))

Archaeological Resource Assessment (ARA) required

Phase 1 archaeological investigation required

Comments: Based on 7/27/23 site visit, an ARA utilizing two backhoe trenches to expose stratigraphic context and prior disturbance will be necessary within the area of the upper parking lot that will be reclaimed and

§106 Project Review Form

For Clean Water Projects funded by the DEC Clean Water Initiative Program

- No Historic Properties/Sites Affected/No Effect
- No Historic Resource Present in Area of Potential Effect
- Work will have No Effect on Historic Resource

Comments:

Vermont State Historic Preservation Office Concurrence and Date:

X: _____

§106 Project Review Form

For Clean Water Projects funded by the DEC Clean Water Initiative Program

Final Project Review Section

To complete Final Project Review, re-submit this VDHP Project Review Form with the following additional elements included. Note that this should be added to the VDHP-signed version of the Preliminary Review Form so VDHP can reference their prior guidance on this project. This Final Project Review Form, once completed and signed by VDHP, should be submitted as a CWIP project deliverable.

- 1. Please provide a short description of any changes to the project’s proposed scope of work since the Preliminary Project Review:

Final project plans include a river access path north of the parking lot to be constructed in fill material and additional landscape details including a placed boulder border along riverside edge of parking area and tree plantings along riverbank. The depth of disturbance for the tree planting will not exceed 20 inches adjacent to and north of the retained parking area and will not exceed 18

- 2. Please attach:

- a. Final (100%) Design Plans
- b. Project narrative description of scope of work (CWIP Final Design Report will suffice)
- c. Any historical resource assessments, or determination of eligibility forms
- d. Any archaeological resource assessments, other archaeological reports, or end-of-field documents
- e. Any Treatment Plans

Email this form and supporting materials to ACCD.ProjectReview@vermont.gov

Please copy scott.dillon@vermont.gov

TO BE COMPLETED BY VDHP:

- No Historic Properties/Sites Affected/No Effect
 - No Historic Resource Present in Area of Potential Effect
 - Work will have No Effect on Historic Resource

Comments: This determination is contingent on receipt of project plans that provide ground disturbance specifications for tree planting that do not exceed 20 inches in depth adjacent or north of the parking area and do not exceed 18

- No Adverse Effect
- Adverse Effect
 - Project Treatment Plan or other agreement documents executed

Other:

Vermont State Historic Preservation Office Concurrence and Date:

X: scott dillon
Digitally signed by scott dillon
 Date: 2024.10.24 11:31:38 -04'00'

DOROTHY SMITH ACCESS AREA FLOODPLAIN RESTORATION

VT 108
JEFFERSONVILLE, VERMONT

100% DESIGN
NOVEMBER II, 2024

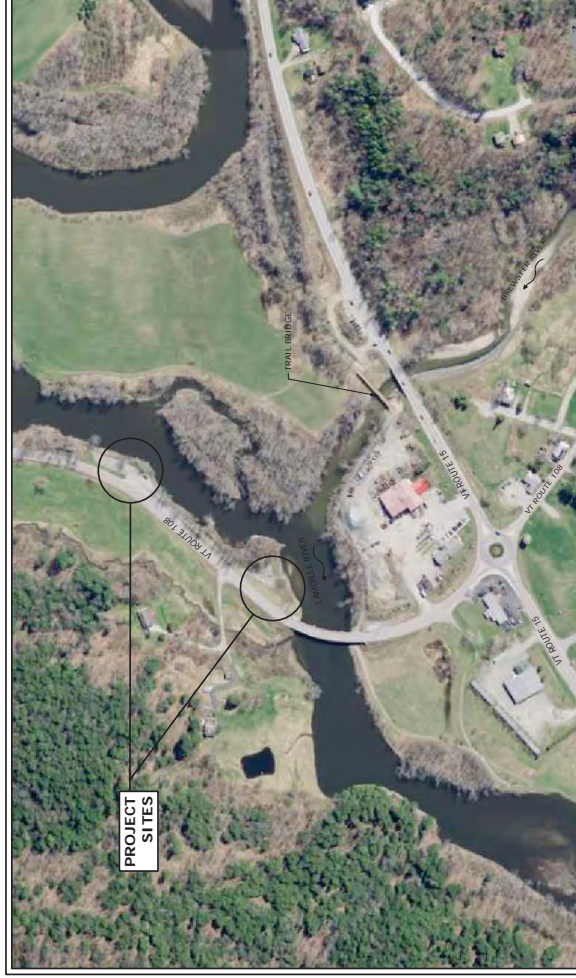

PROJECT SITE VICINITY MAP:



PREPARED BY:



SLR
SLOAN RAYBURN
WATERBURY, VT 05671
802.244.1144
SLR@SLRSLR.COM



Know what's below.
Call before you dig.
www.cbyd.com

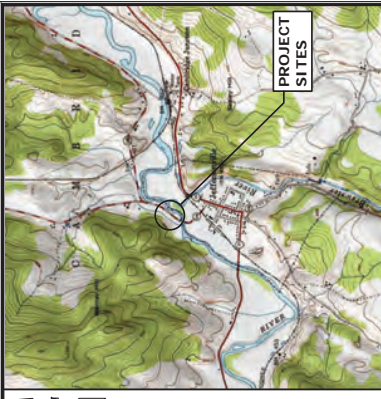

LOCATION MAP:

PREPARED FOR:

LAMOILLE COUNTY REGIONAL PLANNING COMMISSION
52 PORTLAND STREET
MORRISVILLE, VT 05661

LIST OF DRAWINGS

NO.	NAME	TITLE
1		
2	EX-1	SITE PLAN - EXISTING CONDITIONS I
3	EX-2	SITE PLAN - EXISTING CONDITIONS II
4	PR-1	SITE PLAN - PROPOSED CONDITIONS I
5	PR-2	SITE PLAN - PROPOSED CONDITIONS II
6	CON-1	CONSTRUCTION ACCESS, SEQUENCE & CONTROLS
7	XS-1	TYPICAL CROSS-SECTION
8	DET-1	DETAILS
9	B-71B	VTRANS STANDARD DETAIL FOR COMMERCIAL DRIVES

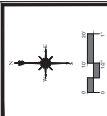

1 SOUTH MAIN STREET
WATERBURY, VT 05671
SLR CONSULTING.COM

DESCRIPTION	DATE	BY

100% DESIGN

SITE PLAN - EXISTING CONDITIONS I
DOROTHY SMITH ACCESS AREA
FLOODPLAIN RESTORATION
JEFFERSONVILLE, VERMONT
VT 108

JCL	DJO	RKS

SCALE: 1"=20'
DATE: NOVEMBER 11, 2024
PROJECT NO.: 12911.00021
SHEET NO.: 2 OF 9

EX-1

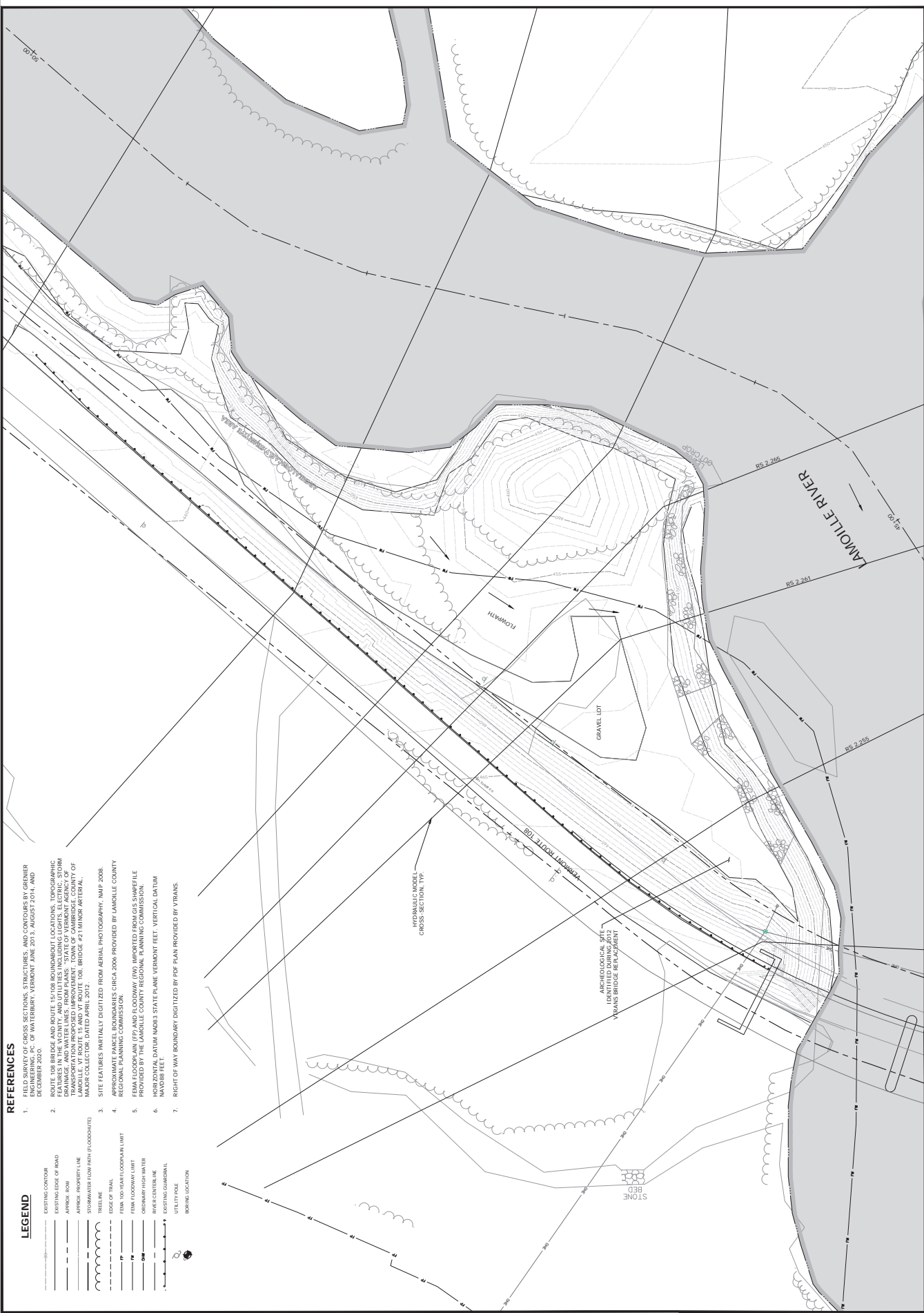

REFERENCES

1. FIELD SURVEY OF CROSS SECTIONS, STRUCTURES, AND CONTOURS BY GRENER CONSULTING, OF WATERBURY, VERMONT JUNE 2013, AUGUST 2014, AND DECEMBER 2020.
2. ROUTE 108 BRIDGE AND ROUTE 15/108 BOUNDARY LOCATIONS, TOPOGRAPHIC FEATURES IN THE VICINITY, AND UTILITIES INCLUDING LIGHTS, ELECTRIC, STORM SEWER, AND WATER MAINS, AND TRANSPORTATION PROPOSED IMPROVEMENT, TOWN OF CAMBRIDGE, COUNTY OF LANOLLE, VT ROUTE 15 AND VT ROUTE 108, BRIDGE #21 MINOR ARTERIAL, MAJOR COLLECTOR, DATED APRIL 2012.
3. SITE FEATURES PARTIALLY DIGITIZED FROM AERIAL PHOTOGRAPHY, MAP 2009, REGIONAL PLANNING COMMISSION.
4. APPROXIMATE PARCEL BOUNDARIES: CIRCA 2009 PROVIDED BY LANOLLE COUNTY REGIONAL PLANNING COMMISSION.
5. FEMA FLOODPLAIN (FP) AND FLOODWAY (FW) IMPORTED FROM GIS SHAPFILE PROVIDED BY THE LANOLLE COUNTY REGIONAL PLANNING COMMISSION.
6. DATUM: MDS3 STATE PLANE VERMONT FEET, VERTICAL DATUM: NAVD83 FEET.
7. RIGHT OF WAY BOUNDARY DIGITIZED BY PDF PLAN PROVIDED BY VRANS.

LEGEND

- EXISTING CONTOUR
- EXISTING EDGE OF ROAD
- APPROX. 50% BOUNDARY
- APPROX. PROPERTY LINE
- STORMWATER FLOW PATH (FLOODGATED)
- TRAIL
- EDGE OF TRAIL
- 100-YEAR FLOODPLAIN LIMIT
- 500-YEAR FLOODPLAIN LIMIT
- DEBRIS-FIELD HIGH WATER
- 50% CENTERLINE
- EXISTING CONDUIT
- EXISTING UTILITY
- EXISTING LOCATION

TRAFFIC MANAGEMENT NOTES

1. ALL TEMPORARY TRAFFIC CONTROL WORK SHALL CONFORM TO THE LATEST EDITION OF THE "MANUAL ON UNIFORM TRAFFIC CONTROL DEVICES" (MUTCD) AND ALL REVISIONS.
2. ALL SOIL LEGENDS, BORDERS, AND MOUNTING SHALL BE IN ACCORDANCE WITH THE MUTCD.
3. ALL SIGNS SHALL BE MOUNTED ON THEIR OWN STANDARD SIGNS SUPPORTS.

EROSION CONTROL NOTES

1. THE SEDIMENT AND EROSION CONTROL PRACTICES IMPLEMENTED AS PART OF THE PROJECT SHALL CONFORM TO THE LATEST EDITION OF THE "MANUAL ON UNIFORM TRAFFIC CONTROL DEVICES" (MUTCD) AND ALL REVISIONS.
2. THE PROJECT ENGINEER SHALL BE RESPONSIBLE FOR THE MAINTENANCE OF ALL SOIL EROSION AND SEDIMENT CONTROL PRACTICES THROUGHOUT THE DURATION OF THE PROJECT.
3. CLEARING OF NATIVE VEGETATION FOR CONSTRUCTION ACCESS SHOULD BE MINIMIZED.
4. ALL SOIL EROSION AND SEDIMENT CONTROL PRACTICES SHALL BE INSTALLED PRIOR TO ANY MAJOR DISTURBANCE OF THE EARTH SURFACE, AND MAINTAINED UNTIL VEGETATION PROTECTION IS ESTABLISHED.
5. THE CONTRACTOR IS RESPONSIBLE FOR THE MAINTENANCE OF ALL SOIL EROSION AND SEDIMENT CONTROL PRACTICES THROUGHOUT THE DURATION OF THE PROJECT.
6. THE PROJECT ENGINEER IS TO BE NOTIFIED IMMEDIATELY IF EXCESSIVE SEDIMENT EROSION TAKES PLACE AT ANY LOCATION. THE PROJECT ENGINEER SHALL BE RESPONSIBLE FOR THE MAINTENANCE, REPAIR, AND REMOVAL OF ALL EROSION CONTROL PRACTICES.
7. PERFORM WORK DURING LOW FLOW PERIODS. IF A LARGE FLOOD IS PREDICTED, STOP WORK, STABILIZE THE SITE, AND REMOVE EQUIPMENT FROM FLOOD PRONE AREAS.
8. EXCESSIVE SEDIMENTATION SHALL BE AVOIDED. EXCESSIVE SEDIMENTATION SHALL BE REPORTED IMMEDIATELY TO THE PROJECT ENGINEER.
9. NO DISTURBED EARTH WILL REMAIN EXPOSED FOR MORE THAN SEVEN (7) CONSECUTIVE DAYS WITHOUT APPLYING TEMPORARY OR PERMANENT STABILIZATION MEASURES AT DIRECTION OF THE PROJECT ENGINEER.
10. EXPOSED AREAS SHALL BE SEEDED AND MULCHED OR PROTECTED WITH EROSION CONTROL MATTING WITHIN 48 HOURS OF ACHIEVING FINAL GRADE.
11. ANY DISTURBED SLOPES 2:1 OR STEEPER SHALL BE STABILIZED WITH EROSION CONTROL BLANKET FOR DIRECTION OF PROJECT ENGINEER. SEE DETAIL.

INVASIVE SPECIES HANDLING NOTES

1. THESE NOTES PROVIDE BEST MANAGEMENT PRACTICES FOR PREVENTING THE SPREAD OF INVASIVE SPECIES. THE CONTRACTOR SHALL BE RESPONSIBLE FOR THE IDENTIFICATION AND IDENTIFICATION OF INVASIVE SPECIES CAN BE FOUND AT WWW.VTINVASIVES.ORG.
2. LOCATE AND USE STAGING AREAS THAT ARE FREE OF INVASIVE SPECIES TO AVOID SPREADING SEEDS AND OTHER VIABLE PLANT PARTS.
3. EQUIPMENT SHALL BE CLEANED AND DECONTAMINATED TO AVOID SPREADING INVASIVE SPECIES INTO AREAS NOT INTENDED WITH INVASIVE SPECIES WHENEVER POSSIBLE.
4. ALL EQUIPMENT, MACHINERY, AND HAND TOOLS USED IN AREAS WHERE INVASIVE PLANTS OCCUR SHALL BE CLEANED AND DECONTAMINATED TO AVOID SPREADING INVASIVE PLANTS TO OTHER AREAS MOVING TO AREAS NOT ALREADY INFESTED. CLEANING SHOULD OCCUR WITHIN THE AREA ALREADY INFESTED. ACCEPTABLE CLEANING METHODS INCLUDE:
 - 4.1. PORTABLE WASH STATION THAT CONTAINS RUNOFF FROM WASHED EQUIPMENT
 - 4.2. BRUSH, BROOM, OR HAND TOOLS USED WITHOUT WATER
 - 4.3. EXCAVATED MATERIAL TAKEN FROM SITES THAT CONTAIN INVASIVE PLANTS CANNOT BE USED AWAY FROM THE PROJECT SITE. EXCAVATED MATERIAL MAY BE REUSED WITHIN THE EXACT LIMITS OF INFESTATION.
 - 4.4. ANY EXTRA EXCAVATED MATERIAL CONTAINING INVASIVE PLANT MATERIAL MUST BE STOCKPILED ON BURNING MATS AT LEAST 5 FEET BELOW GROUND FOR PHRAGMATES AND KNOTWEED OR 3 FEET FOR OTHER SPECIES.
 - 4.5. SOIL AND OTHER MATERIALS CONTAINING INVASIVE PLANT MATERIAL MUST BE COVERED DURING TRANSPORT.
 - 4.6. INVASIVE SPECIES CAN BE REMOVED REMOVED BY THE FOLLOWING METHODS:
 - 8.1. BURNING NOxious WEEDS THAT ARE NOT SEEDING OR FLOWERING IS ACCEPTABLE. PLANT MATERIAL SHOULD BE TAKEN TO A DESIGNATED BURN PILE. MAKE SURE THAT ANY REMAINING BURNING ROOT FRAGMENTS ARE NON-VIABLE. OBTAIN ALL NECESSARY PERMITS BEFORE BURNING.
 - 8.2. BURNING NOxious WEEDS IS ACCEPTABLE. SOME WEEDS SUCH AS JAVANESSE KNOTWEED SHOULD BE BURIED AT LEAST 4' DEEP AND USUALLY WOULD HAVE A BARRIER ON TOP OF THE DISPOSAL SITE.
 - 8.3. CHEMICAL TREATMENT BY A CERTIFIED APPLICATOR WHO FOLLOWS THE LABEL DIRECTIONS IS ACCEPTABLE.
5. INVASIVE SPECIES INCLUDING PHRAGMATES, AND BURBLE LOOSESTRIFE WILL BE MONITORED BY OTHERS CONCURRENTLY WITH THE ACE MONITORING REQUIREMENTS AND ANY OBSERVATIONS AND/OR PROPOSED MANAGEMENT WILL BE INCLUDED IN THE ACE REPORT.



1 SOUTH MAIN STREET
WARRINGTON, VT 05647
SLRCONSULTING.COM

DATE: NOVEMBER 11, 2024
PROJECT NO.: 12911.0005.1
SHEET NO.: 6 OF 9

DATE: NOVEMBER 11, 2024
PROJECT NO.: 12911.0005.1
SHEET NO.: 6 OF 9

100% DESIGN

DATE: NOVEMBER 11, 2024
PROJECT NO.: 12911.0005.1
SHEET NO.: 6 OF 9

100% DESIGN

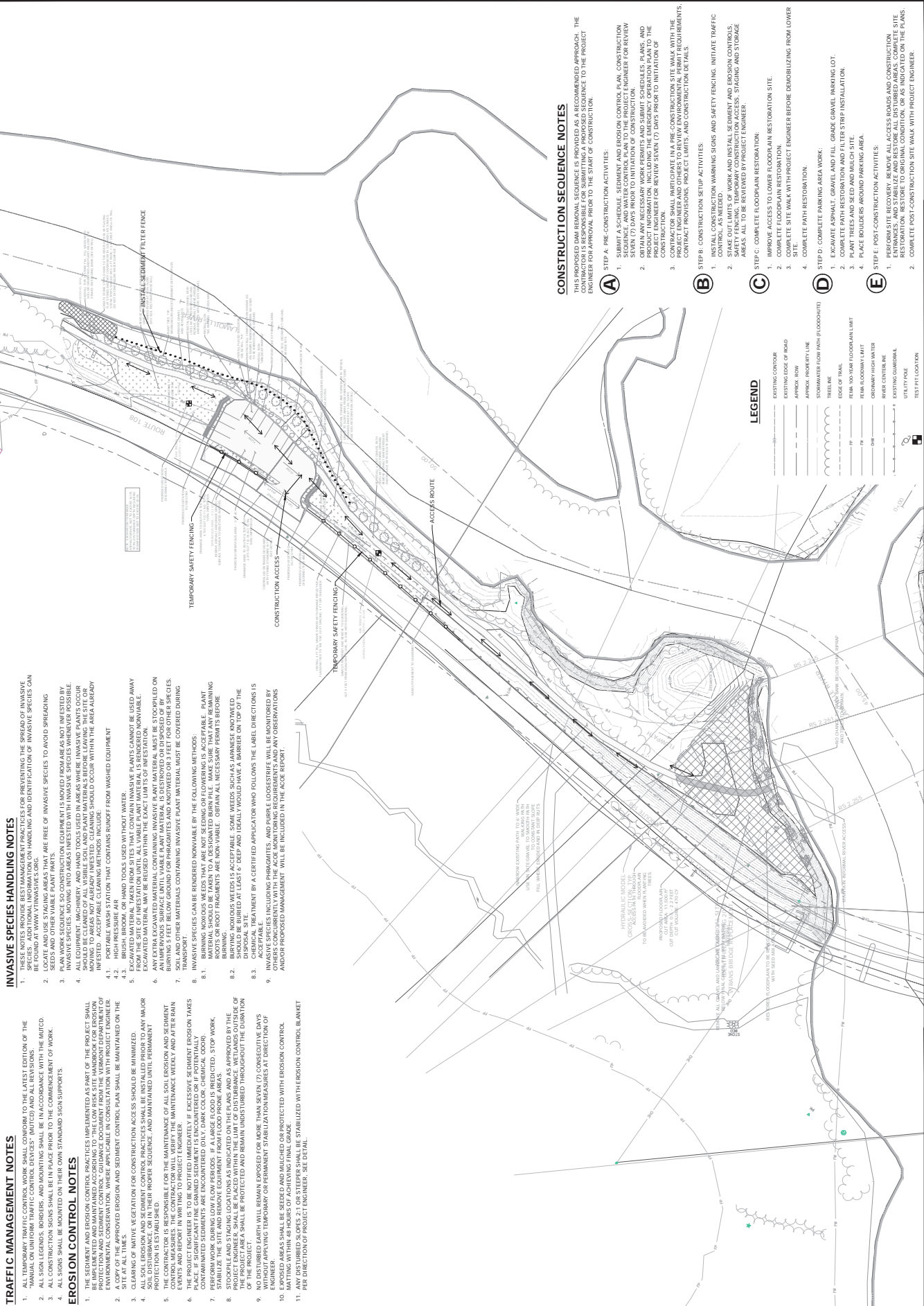

LEGEND

---	EXISTING CONTOUR
---	EXISTING EDGE OF ROAD
---	APPROX. ROW
---	APPROX. PROPOSED EPL LINE
---	STORMWATER FLOW PATH (FLOODWAYS)
---	TRAILLINE
---	EDGE OF TRAIL
---	FEAR 100-YEAR FLOODPLAIN LIMIT
---	FEAR FLOODWAY LIMIT
---	ORDINARY HIGH WATER
---	RIVER CENTERLINE
---	EXISTING GUARDRAIL
---	UTILITY POLE
---	TEST PIT LOCATION

CONSTRUCTION SEQUENCE NOTES

- THIS PROPOSED DAM REMOVAL SEQUENCE IS PROVIDED AS A RECOMMENDED APPROACH. THE CONTRACTOR SHALL BE RESPONSIBLE FOR OBTAINING ALL NECESSARY PERMITS AND FOR THE PROJECT ENGINEER FOR APPROVAL PRIOR TO THE START OF CONSTRUCTION.
- A PRE-CONSTRUCTION ACTIVITIES:**
 1. SUBMIT A SCHEDULED SEDIMENT AND EROSION CONTROL PLAN, CONSTRUCTION CONTROL PLAN, AND CONSTRUCTION CONTROL PLAN TO THE PROJECT ENGINEER SEVEN (7) DAYS PRIOR TO INITIATION OF CONSTRUCTION.
 2. OBTAIN ANY NECESSARY WORK PERMITS AND SUBMIT SCHEDULES, PLANS, AND CONSTRUCTION DETAILS TO THE PROJECT ENGINEER FOR REVIEW SEVEN (7) DAYS PRIOR TO INITIATION OF CONSTRUCTION.
 3. NOTIFY STATE AND FEDERAL AGENCIES AND OTHERS TO REVIEW ENVIRONMENTAL PERMIT REQUIREMENTS, CONTRACT PROVISIONS, PROJECT LIMITS, AND CONSTRUCTION DETAILS.
 - B CONSTRUCTION SETUP ACTIVITIES:**
 1. INSTALL CONSTRUCTION WARNING SIGNS AND SAFETY FENCING. INITIATE TRAFFIC CONTROL, AS NEEDED.
 2. STAKE OUT LIMITS OF WORK AND INSTALL SEDIMENT AND EROSION CONTROL PRACTICES. ALL AREAS ALL TO BE REVIEWED BY PROJECT ENGINEER.
 - C COMPLETE FLOODPLAIN RESTORATION:**
 1. IMPROVE ACCESS TO LOWER FLOODPLAIN RESTORATION SITE.
 2. COMPLETE FLOODPLAIN RESTORATION.
 3. COMPLETE SITE WALK WITH PROJECT ENGINEER BEFORE DEMOBILIZING FROM LOWER FLOODPLAIN RESTORATION SITE.
 - D COMPLETE PARKING AREA WORK:**
 1. EXCAVATE ASPHALT, GRAVEL AND FILL, GRAVE GRAVEL PARKING LOT.
 2. COMPLETE PATH RESTORATION AND FILTER STRIP INSTALLATION.
 3. PLANT TREES AND SEED AND MULCH SITE.
 4. PLACE BOLLARDS AROUND PARKING AREA.
 - E POST-CONSTRUCTION ACTIVITIES:**
 1. PERFORM SITE RECOVERY. REMOVE ALL ACCESS ROADS AND CONSTRUCTION MATERIALS FROM THE CONSTRUCTION SITE. COMPLETE SITE WALK WITH PROJECT ENGINEER.
 2. COMPLETE POST-CONSTRUCTION SITE WALK WITH PROJECT ENGINEER.



SLR
 1 SOUTH MAIN STREET
 WATERBURY VT 05671
 SLRCONSULTING.COM

NO.	DESCRIPTION	DATE	BY

100% DESIGN

TYPICAL CROSS-SECTION
 DOROTHY SMITH ACCESS AREA
 FLOODPLAIN RESTORATION
 JEFFERSONVILLE, VERMONT
 VT 108

JCL	DJO	RKS

PROJ. NO. 12811.00021
 SHEET NO. 7 OF 9
XS-1

DATE: NOVEMBER 11, 2024
 SCALE: H: 1" = 50'
 V: 1" = 10'

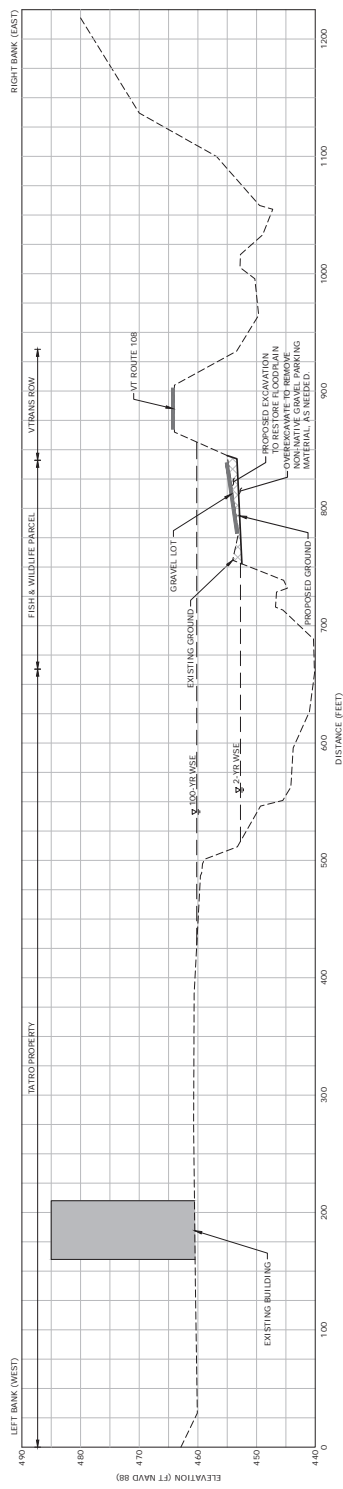

TYPICAL CROSS-SECTION (RS 6.261)

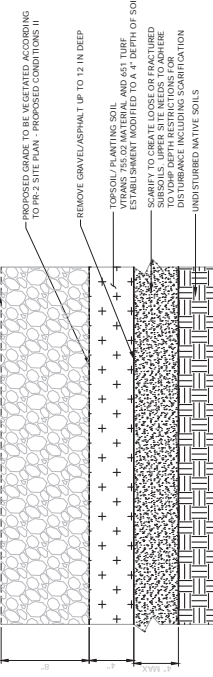

SOIL RESTORATION
NOT TO SCALE

NOTE: SOILS HAVE BEEN PLACED AND GRADED SUITABLE FOR VEGETATION OF PLANTS SPECIFIED IN THE PR-2 SITE PLAN. THE CONTRACTOR SHALL VERIFY THE PLACEMENT AND GRADE OF SOILS AND RECORD THE SAME IN THE FIELD. PROTECT EXISTING SOILS FROM EROSION AND SOIL LOSS.

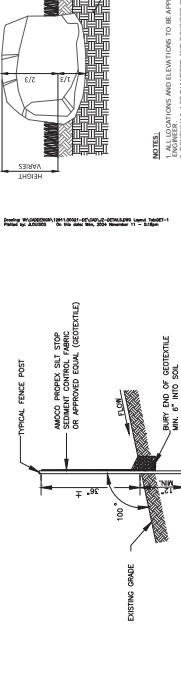

SEDIMENT FILTER FENCE
NOT TO SCALE

NOTE: CONTRACTOR SHALL COORDINATE TEMPORARY FENCE INSTALLATION WITH OWNERS REPRESENTATIVES. SEE DETAIL FOR FENCE INSTALLATION. APPROVALS PRIOR TO CONSTRUCTION.

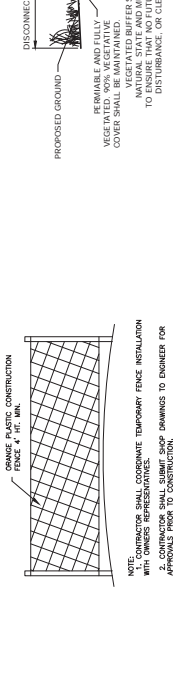

ORANGE CONSTRUCTION SAFETY FENCING
NOT TO SCALE

NOTE: CONTRACTOR SHALL COORDINATE TEMPORARY FENCE INSTALLATION WITH OWNERS REPRESENTATIVES. SEE DETAIL FOR FENCE INSTALLATION. APPROVALS PRIOR TO CONSTRUCTION.

- SOIL RESTORATION NOTES**
1. PRESERVE EXISTING NON-INVASIVE VEGETATION AND TREES ON THE RIVER BANK TO THE EXTENT POSSIBLE.
 2. ALL CLEAN STOCKPILED TOPSOIL WITH NO INVASIVE SPECIES SHOULD BE REINSTALLED ON FLOODPLAIN AND DISTURBED AREAS SHALL RECEIVE A MINIMUM OF 4\"/>

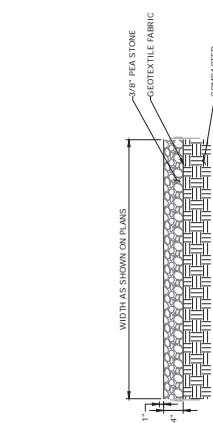

GRAVEL PARKING SURFACE
NOT TO SCALE

NOTE: REUSE OF EXISTING CLEAN GRAVEL MAY BE APPROVED BY THE ENGINEER. APPROVALS PRIOR TO CONSTRUCTION.



PLACED BOULDER
NOT TO SCALE

NOTE: REUSE OF EXISTING CLEAN GRAVEL MAY BE APPROVED BY THE ENGINEER. APPROVALS PRIOR TO CONSTRUCTION.

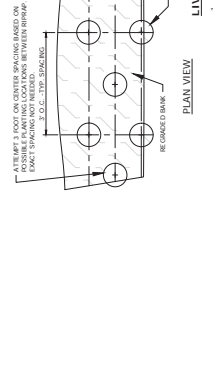

LIVE STAKE PLANTINGS
NOT TO SCALE

NOTE: SUPPORT STAKES SHALL BE REMOVED BY THE CONTRACTOR ONE YEAR AFTER INSTALLATION.



TREE PLANTING
NOT TO SCALE

NOTE: SUPPORT STAKES SHALL BE REMOVED BY THE CONTRACTOR ONE YEAR AFTER INSTALLATION.

DATE	DESCRIPTION	BY

DETAILS

DOROTHY SMITH ACCESS AREA

FLOODPLAIN RESTORATION

JEFFERSONVILLE, VERMONT

VT 108

RKS

DJO

JCL

AS NOTED

NOVEMBER 11, 2024

12911.00051

8 OF 9

DET-1

LIVE STAKE JOINT PLANTING NOTES

1. SHIRAZ WILLOW AND DOGWOOD BRANCHES MUST BE HARVESTED DORMANT. COLD STORAGE IS REQUIRED. BRANCHES SHOULD BE STORED IN A COOL, DRY PLACE.
2. WILLOW AND DOGWOOD BRANCHES SHOULD BE HARVESTED USING THE "STRAPER" TOOL PERMANENTLY TO AVOID DAMAGE TO THE BRANCHES.
3. INSTALL 1\"/>

LIVE STAKE PLANTINGS
NOT TO SCALE

NOTE: SUPPORT STAKES SHALL BE REMOVED BY THE CONTRACTOR ONE YEAR AFTER INSTALLATION.

TREE PLANTING
NOT TO SCALE

NOTE: SUPPORT STAKES SHALL BE REMOVED BY THE CONTRACTOR ONE YEAR AFTER INSTALLATION.

DISCONNECTION TO VEGETATED AREA
NOT TO SCALE

NOTE: SUPPORT STAKES SHALL BE REMOVED BY THE CONTRACTOR ONE YEAR AFTER INSTALLATION.

SOIL RESTORATION NOTES

1. PRESERVE EXISTING NON-INVASIVE VEGETATION AND TREES ON THE RIVER BANK TO THE EXTENT POSSIBLE.
2. ALL CLEAN STOCKPILED TOPSOIL WITH NO INVASIVE SPECIES SHOULD BE REINSTALLED ON FLOODPLAIN AND DISTURBED AREAS SHALL RECEIVE A MINIMUM OF 4\"/>

**U.S. Army Corps of Engineers (USACE)
APPLICATION FOR DEPARTMENT OF THE ARMY PERMIT**

*Form Approved -
OMB No. 0710-0003
Expires: 2027-03-31*

For use of this form, see 33 CFR 325. The proponent agency is CECW-COR.

The public reporting burden for this collection of information, OMB Control Number 0710-0003, is estimated to average 11 hours per response, including the time for reviewing instructions, searching existing data sources, gathering and maintaining the data needed, and completing and reviewing the collection of information. Send comments regarding the burden estimate or burden reduction suggestions to the Department of Defense, Washington Headquarters Services, at whs.mc-alex.esd.mbx.dd-dod-information-collections@mail.mil. Respondents should be aware that notwithstanding any other provision of law, no person shall be subject to any penalty for failing to comply with a collection of information if it does not display a currently valid OMB control number. PLEASE DO NOT RETURN YOUR APPLICATION TO THE ABOVE EMAIL.

PRIVACY ACT STATEMENT

Authorities: Rivers and Harbors Act, Section 10, 33 USC 403; Clean Water Act, Section 404, 33 USC 1344; Marine Protection, Research, and Sanctuaries Act, Section 103, 33 USC 1413; Regulatory Programs of the Corps of Engineers; Final Rule 33 CFR 320-332. Principal Purpose: Information provided on this form will be used in evaluating the application for a permit. Routine Uses: This information may be shared with the Department of Justice and other federal, state, and local government agencies, and the public and may be made available as part of a public notice as required by Federal law. Submission of requested information is voluntary, however, if information is not provided the permit application cannot be evaluated nor can a permit be issued. One set of original drawings or good reproducible copies which show the location and character of the proposed activity must be attached to this application (see sample drawings and/or instructions) and be submitted to the District Engineer having jurisdiction over the location of the proposed activity. An application that is not completed in full will be returned. System of Record Notice (SORN). The information received is entered into our permit tracking database and a SORN has been completed (SORN #A1145b) and may be accessed at the following website: <http://dpcl.dod.defense.gov/Privacy/SORNs/Index/DOD-wide-SORN-Article-View/Article/570115/a1145b-ce.aspx>

(ITEMS 1 THRU 4 TO BE FILLED BY THE CORPS)

1. APPLICATION NO.	2. FIELD OFFICE CODE	3. DATE RECEIVED	4. DATE APPLICATION COMPLETE
--------------------	----------------------	------------------	------------------------------

(ITEMS BELOW TO BE FILLED BY APPLICANT)

5. APPLICANT'S NAME First - Mike Middle - Last - Wichrowski Company - Vermont Fish & Wildlife Department E-mail Address - mike.wichrowski@vermont.gov	8. AUTHORIZED AGENT'S NAME AND TITLE (agent is not required) First - Jessica Middle - C Last - Louisos Company - SLR Consulting E-mail Address - jlouisos@slrconsulting.com
6. APPLICANT'S ADDRESS: Address- 1 National Life, Davis 2 City - Montpelier State - VT Zip - 05320 Country - USA	9. AGENT'S ADDRESS: Address- 1 South Main Street, 2nd Floor City - Waterbury State - VT Zip - 05676 Country - USA
7. APPLICANT'S PHONE NOs. w/AREA CODE a. Residence b. Business c. Fax 802-917-1347	10. AGENTS PHONE NOs. w/AREA CODE a. Residence b. Business c. Fax 802-882-8335

STATEMENT OF AUTHORIZATION

11. I hereby authorize, Jessica Louisos to act in my behalf as my agent in the processing of this application and to furnish, upon request, supplemental information in support of this permit application.

SIGNATURE OF APPLICANT

DATE

NAME, LOCATION, AND DESCRIPTION OF PROJECT OR ACTIVITY

12. PROJECT NAME OR TITLE (see instructions) Dorothy Smith Access Area, Floodplain Restoration	
13. NAME OF WATERBODY, IF KNOWN (if applicable) Lamoille River	14. PROJECT STREET ADDRESS (if applicable) Address 1 Route 108 City - Jeffersonville State- VT Zip- 05464
15. LOCATION OF PROJECT Latitude: +N 44.649903 Longitude: -W -72.829925	
16. OTHER LOCATION DESCRIPTIONS, IF KNOWN (see instructions) State Tax Parcel ID 123-038-11924 Municipality Jeffersonville Section - Township - Range -	

17. DIRECTIONS TO THE SITE

Vermont Route 108 between Blackberry Hill Drive and Route 109 on east side of road. there is a large gravel pull off / turn around along Route 108 at the site, adjacent to the Lamoille River.

18. Nature of Activity (Description of project, include all features)

Water quality and floodplain improvements to an existing public access area. Removal of asphalt and gravel parking, restoration of soils, planting of vegetation, controlling vehicle access with boulders, stabilization of river bank, installation of stone steps for river access, and removal of fill from the floodplain. No buildings, utilities, fill, or new impervious surface.

19. Project Purpose (Describe the reason or purpose of the project, see instructions)

The purpose of the project is to improve water quality and flood storage at the site. This location is at the confluence of the Lamoille and Brewster Rivers. It was identified for restoration both in a flood study of the municipality and a stormwater master plan. There are components of the project that are targeted for both goals. Overall the project will allow for more flood waters onto the site to catch debris and ice as well as allowing runoff to filter through vegetation before entering the river. The reduction of impervious surface and increase in vegetation work together towards these goals. The streambank stabilization and public access steps to the river further the goals of the public fishing access property to allow people to gain access to the river.

USE BLOCKS 20-23 IF DREDGED AND/OR FILL MATERIAL IS TO BE DISCHARGED

20. Reason(s) for Discharge

The river bank is collapsing and eroding where vegetation had historically been removed. The bank stabilization is being paired with revegetation and installation of stone steps for public access.

21. Type(s) of Material Being Discharged and the Amount of Each Type in Cubic Yards:

Type Amount in Cubic Yards	Type Amount in Cubic Yards	Type Amount in Cubic Yards
80 CY stone and fill for bank stabilization		

22. Surface Area in Acres of Wetlands or Other Waters Filled (see instructions)

Acres
or
Linear Feet 65

23. Description of Avoidance, Minimization, and Compensation (see instructions)

Avoidance was considered, but the bank erosion is expected to continue to erode into the public access area. The bank stabilization was paired with river access to concentrate impacts into one location on the bank.

24. Is Any Portion of the Work Already Complete? Yes No IF YES, DESCRIBE THE COMPLETED WORK

25. Addresses of Adjoining Property Owners, Lessees, Etc., Whose Property Adjoins the Waterbody (if more than can be entered here, please attach a supplemental list).

a. Address- G.W.Tatro, 16 W. Tatro Drive

City - Jeffersonville State - VT Zip - 05464

b. Address- Robert and Tanya Nuzzo, PO Box 321

City - Jeffersonville State - VT Zip - 05464

c. Address- Christopher Feruson, 254 Blackberry Hill Drive

City - Jeffersonville State - VT Zip - 0546

d. Address- Susan Roussin, 217 Blackberry Hill Drive

City - Jeffersonville State - VT Zip - 05464

e. Address- Paul Clarke, 7 Tautemo Way

City - Nantucket State - MA Zip - 02554

26. List of Other Certificates or Approvals/Denials received from other Federal, State, or Local Agencies for Work Described in This Application.

AGENCY	TYPE APPROVAL*	IDENTIFICATION NUMBER	DATE APPLIED	DATE APPROVED	DATE DENIED
VTANR	Stream Alteration				
VTANR	Floodplain				
SHPO	Review				

* Would include but is not restricted to zoning, building, and flood plain permits

27. Application is hereby made for permit or permits to authorize the work described in this application. I certify that this information in this application is complete and accurate. I further certify that I possess the authority to undertake the work described herein or am acting as the duly authorized agent of the applicant.

SIGNATURE OF APPLICANT

DATE

SIGNATURE OF AGENT

DATE

The Application must be signed by the person who desires to undertake the proposed activity (applicant) or it may be signed by a duly authorized agent if the statement in block 11 has been filled out and signed.

18 U.S.C. Section 1001 provides that: Whoever, in any manner within the jurisdiction of any department or agency of the United States knowingly and willfully falsifies, conceals, or covers up any trick, scheme, or disguises a material fact or makes any false, fictitious or fraudulent statements or representations or makes or uses any false writing or document knowing same to contain any false, fictitious or fraudulent statements or entry, shall be fined not more than \$10,000 or imprisoned not more than five years or both.



FLOOD HAZARD AREA & RIVER CORRIDOR RULE

General Permit Application

Category 10 V.S.A. § 754

A. Category of Development Exempt from Municipal Regulation		
<input checked="" type="checkbox"/> State-owned and operated institution and facility	<input type="checkbox"/> Accepted agricultural or silvicultural practice	
<input type="checkbox"/> Power generating, transmission, or telecommunication facility subject to Section 248/248a		
B. Applicant		
1. Applicant Name: Vermont Fish & Wildlife Department, c/o Mike Wichrowski		
2. Mailing Address: 1 National Life Drive, Davis 2		
3. Town: Montpelier	4. State: VT	5. Zip: 05620
6. Phone: 8029171347	7. Cell Phone:	
8. Email Address: mike.wichrowski@vermont.gov		
C. Landowner		
1. Landowner Name: same		
2. Mailing Address:		
3. Town:	4. State:	5. Zip:
6. Phone:	7. Email Address:	
D. Consultant or Designer		
1. Consultant Company Name: SLR Consulting		
2. Consultant or Designer Name: Jessica Louisos, PE		
3. Phone: 802-882-8335	4. Email: jlouisos@slrconsulting.com	
5. Contractor Business Name:		
6. Contractor Name:		
7. Phone:	8. Email:	
E. Project Information		
1. Project Location Address: 1 Vermont Route 108, Jeffersonville, VT 05464		
2. Project Location SPAN (School Parcel Account Number) 11 digit number: <u>1</u> <u>2</u> <u>3</u> - <u>0</u> <u>3</u> <u>8</u> - <u>1</u> <u>1</u> <u>9</u> <u>2</u> <u>3</u>		
3. Project Location Town: Jeffersonville		
4. Flooding source: Lamoille River		
5a. Latitude: 44.649903	5b. Longitude: -72.829925	

F. Project Description

1. General description of the proposed development:

Water quality and floodplain improvements to an existing public access area. Removal of asphalt and gravel parking, restoration of soils, planting of vegetation, controlling vehicle access with boulders, stabilization of river bank, installation of stone steps for river access, and removal of fill from the floodplain. No buildings, utilities, fill, or new impervious surface.

G. Eligible Activity (Section V(c)(1) of the General Permit)

Please check the box applicable to your proposed project. If none of the following apply, your project may require a different type of application or notice. For more information, contact the regional floodplain manager:

<http://dec.vermont.gov/watershed/ivers/river-corridor-and-floodplain-protection/floodplain-managers>

- Improvement or repair to an existing structure (walled/roofed building) in the flood hazard area, costing less than 50% of the fair market value of the structure.
- Construction or placement of an accessory structure less than 500 square feet in size in the flood hazard area, but not in the floodway or river corridor. The accessory structure must meet the standards in Section VI of the [Flood Hazard Area & River Corridor General Permit](#).
- Construction of temporary equipment access in a flood hazard area that may result in temporary fill placement exceeding one construction season for maintenance, construction, or repair work, and that will be stored to pre-construction conditions at the end of the construction project and does not result in any increases to published base flood elevations (BFEs).
- Agricultural waste storage facilities that meet the standards in Section VI of the Flood Hazard Area & River Corridor General Permit
- New development that is located outside of the flood hazard area, but within the river corridor that complies with the requirements of Appendices A or B of the [Flood Hazard Area and River Corridor Protection Procedure](#) or that is within a designated center or farm production area and is not any closer to the river than immediately adjacent development.
- Restoration projects to restore natural floodplain function including berm removal, natural channel design, floodplain excavations, wetland habitat improvements and dam removal.

H. Submittal requirements (please attach the following with this form as appropriate to the proposed development):

- A map clearly showing the location of the proposed activity. To expedite review and authorization, provide a map generated from the ANR Natural Resources Atlas showing the river corridor and flood hazard area (if available) (<http://anr.vermont.gov/maps>);
- A written description of the proposed project that clearly indicates which activity will be conducted under Section V(c)(1) of the [General Permit](#) and provide sufficient technical details demonstrating how it will meet the Flood Hazard Area & River Corridor Standards (Section VI of the General Permit);
- For improvements or repairs to existing structures, the costs of materials, labor and, for work in excess of \$5,000.00, and an estimate of fair market value (recent appraisal or tax assessment); and
- Contact information, including names and mailing addresses, and if available, email addresses and phone numbers for landowners, contractors, and consultants.

I. Certification

CERTIFICATION: I hereby certify that the information on this application is, to the best of my knowledge, true and accurate. I recognize that by signing this notice I am giving consent to employees of the State to enter the subject property for the purpose of processing this application and for ensuring compliance with subsequent agency decisions relating to the project as required in the Vermont Flood Hazard Area and River Corridor General Permit.

Print Full Name Christopher Herrick

Applicant Signature:  Date 11/13/2024

Please submit this form to the appropriate Regional Floodplain manager.

To see the current Floodplain Manager regions, please refer to:

<http://dec.vermont.gov/watershed/rivers/river-corridor-and-floodplain-protection/floodplain-managers>

Direct all correspondence or questions to the appropriate Regional Floodplain Manager or to the Rivers Program general inbox at:

ANR.WSMDRivers@vermont.gov

For additional information visit: <http://dec.vermont.gov/watershed>

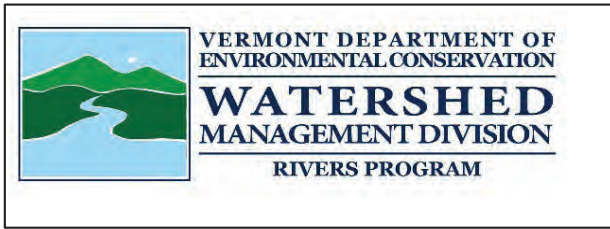

Application Form for coverage under the Stream Alteration General Permit

(SECTION C.2.2) 10 VSA, SECTIONS and 10 VSA, CHAPTER 41, SUBCHAPTER 2

For Stream Alteration Permitting Use Only. Application Number: _____

It is strongly recommended prior to your submission of this application to have a site visit with the Department of Environmental Conservation (DEC) - Rivers Management Engineer in your area. For engineer and district contact information, please visit our website: https://dec.vermont.gov/sites/dec/files/wsm/rivers/docs/RME_districts.pdf

Site Visit Date: _____ **DEC Engineer:** _____

Instructions: To be administratively complete, provide all information on the form and submit the \$200.00 application review fee, and required attachments using ANR Online: https://anronline.vermont.gov/?formtag=WSMD_Intake. Permit Applications are subject to a 14 day comment period, unless exempted by an emergency order. More instructions on page 3 of this form.

Permit Registration - \$200.00 Review Fee (Registrations are for low-risk activities, (bridge repairs, structure replacement)

Permit Application - \$200.00 Review Fee (Applications are required for moderate and high-risk activities)

This is an urgent flood recovery project that repairs damage following an emergency declaration.

This project is receiving funding through the American Rescue Plan Act (ARPA).

A. Applicant Contact Information (All information in this section is required):

1. Name and Title: Vermont Fish & Wildlife Department, c/o Mike Wichrowski

2a. Mailing Address: 1 National Life, Davis 2

2b. Town: Montpelier

2c. State: VT

2d. Zip: 05320

3. Phone: 802-917-1347

4. Email: mike.wichrowski@vermont.gov

B. Landowner (Required, if applicant is the sole landowner for the project indicate "Same" below):

1. Name: Same

2a. Mailing Address:

2b. Town:

2c. State:

2d. Zip:

3. Phone:

4. Email:

C. Project Location (Either address or Latitude and Longitude coordinates are required):

1. Address: 1 Vermont Route 108

2. Town: Jeffersonville

3. River: Lamoille River

Verify project location using the [ANR Atlas Map](#)

4a. Latitude: 44.649903

4b. Longitude: -72.829925

5. If there is more than one project location, enter the second address or Lat/Long:

D. Contractor/Consultant (If applicable):

1. Name: SLR Consulting, Jessica Louisos, PE

2a. Mailing Address: 1 South Main Street, 2nd Floor

2b. Town: Waterbury

2c. State: VT

2d. Zip: 05676

3. Email: jlouisos@slrconsulting.com

4. Phone: 802-882-8335

E. Project Description (This section is required): (i.e. Materials used, project area, and proposed outcome)

Water quality and floodplain improvements to an existing public access area. Removal of asphalt and gravel parking, restoration of soils, planting of vegetation, controlling vehicle access with boulders, stabilization of river bank, installation of stone steps for river access, and removal of fill from the floodplain. No buildings, utilities, fill, or new impervious surface.

F. Please check the boxes for required attachments below. Applications submitted without the required attachments will not be forwarded for technical review. (Additional information may be required after initial application review)

- Location Map
- Project design drawings including: plan view, cross sections, existing & proposed conditions, bankfull width and applicable engineering reports

G. Application Certification:

As the applicant for a Stream Alteration permit, I certify that I own in fee the property on which the project proposed in this application will be constructed.

OR

If I am not the legal owner of the property for any projects included in this application, the landowner has given permission by signing this document for the proposed project(s), OR I have obtained written permission from the landowner, OR I have an easement or other legal instrument granting me access to the property to construct the proposed project. I have included with this application written permission from the landowner, OR a copy of any easement OR document conveying access to the property.

I hereby recognize that the receipt of coverage under terms of Stream Alteration General Permit does not convey any property rights in either real or personal property and does not constitute permission of landowners or easement holders.

The information provided in this application is true, accurate, and complete to the best of my knowledge. I recognize the legal and ethical responsibility connected to the information provided in this application, and I understand that the approval of my project depends on the accuracy of the information presented.

By signing this application, I give consent to authorized state employees to enter the property to review and process this application and ensure it follows the decisions made by relevant agencies for the proposed project. I understand that these actions are necessary to properly evaluate and handle my application.

Applicant Signature: DocuSigned by:
Christopher Herrick
77E04AFCF14447F... Date: 11/13/2024

Print Full Name, and title if applicable: Christopher Herrick - Commissioner

Landowner Signature if applicable: DocuSigned by:
Christopher Herrick
77E04AFCF14447F... Date: 11/13/2024

Print Full Name, and title if applicable: Christopher Herrick - Commissioner

A PERMIT MAY BE REQUIRED FROM THE US ARMY CORPS OF ENGINEERS

For information contact: US Army Corps of Engineers, VT Project Office, 8 Carmichael Street Suite 205, Essex Jct VT 05452 802-872-2893

APPROVALS OF SUBMITTED APPLICATIONS DO NOT CONVEY ANY LAND USE RIGHTS TO THE APPLICANT

The application fee for this permit is \$200.00

Refund Policy:

Please submit form, required attachments, and payment using ANROnline at https://anronline.vermont.gov/?formtag=WSMD_Intake

Permit Review Fees are non-refundable unless an application is withdrawn prior to administrative review.

If unable to submit online, mail the completed application form and required attachments along with a check for the application fee made payable to State of Vermont to:

Vermont Department of Environmental Conservation
Watershed Management Division
1 National Life Drive, Davis 3
Montpelier, VT 05620-3522

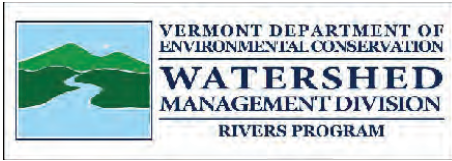

Stream Alteration General Permit Application Instructions

1. This application is for use by anyone proposing to alter by excavation, movement, or fill of greater than 10 cubic yards in any perennial stream and the activity does not qualify for coverage under [in General Permit Section C.2.1 Non-Reporting Activities](#). Indicate if this is a Registration or a General Permit application.
2. Check the box if this application is in response to flooding as defined by an emergency declaration. Check the box if this project has [state ARPA \(American Rescue Plan Act\) funding](#) or is anticipated to receive funding following the approval of this project.
3. Provide the applicant's name and contact information; may be landowner, municipality, contractor or other. The applicant is responsible for implementing the terms of the permit. If there is more than one applicant, attach additional pages to this application.
4. Provide contact information for the owner of the land on which the project will occur. If the applicant is the same as the landowner, write "same" in the name field. If the applicant is different from the landowner, complete the contact information. If there is more than one landowner, attach additional pages to this application.
5. Provide name, phone number and email for consultant or project designer, if involved, and contractor, if known.
6. Provide a brief project description including type of activity, approximate magnitude of project, etc.
7. Describe location by town, address (if known), stream (if named), and latitude/longitude. To locate Lat/Long coordinates using a computer visit <https://anrmaps.vermont.gov/websites/anra5>. Right click your location to show Lat/Long Coordinates at the top of the pop up, or plot coordinates to identify Lat/Long location.
8. Attach location map from ANR Atlas including lat/long, topography, and wetlands layers. Web accessible maps are available at link provided above in #6.
9. Attach a copy of all design drawings, including existing and proposed conditions, plan view, cross sections, and any other pertinent hydraulic, hydrologic, structural, or property boundary information. Plan view typically should extend beyond the construction site so that larger scale stream processes can be identified and considered in the design and regulatory decision. It is preferred but not necessary that design drawings be drawn to scale. In some cases, to-scale drawings may be required.
10. Provide copies of municipal flood hazard area maps wherever any stream crossing structure or other flood plain encroachment is proposed within a mapped flood hazard area.
11. Applicant shall certify, sign and date the application. If the applicant is not the landowner, the landowner shall sign and date the application OR the applicant must attach written permission, easement documentation, or similar, to this application. If the applicant is a business, municipality, or other entity, the signature must be provided by one of the following:
 - the person listed as the registered agent with the Secretary of State;
 - an executive figure such as the president, chairperson or superintendent; or
 - an individual whose status as an authorized representative is verified in writing by the registered agent or executive figure.
12. A fee is required for activities requiring a written authorization under the [Stream Alteration Rule](#). This includes: New, replacement, and repair of bridges and culverts as specified in the GP; and lower risk instream activities NOT associated with the next flood or emergency protection of municipal infrastructure and habitable structures (Effective July 1, 2015). The application fee for this permit is \$200. Please submit form, required attachments, and payment using ANROnline at https://anronline.vermont.gov/?formtag=WSMD_Intake. Instructions provided on the following page.



Department of Environmental Conservation
 Watershed Management Division
 1 National Life Drive, Davis 3
 Montpelier, Vermont 05620-3522
<https://dec.vermont.gov/watershed>



Agency of Natural Resources

[phone] 802-828-1115

SUBMIT AND PAY ONLINE TO SPEED UP YOUR APPLICATION PROCESSING!

You can submit your application and pay fees online. To start, visit:

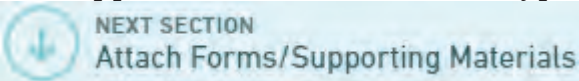
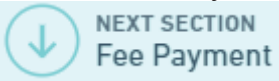
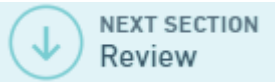
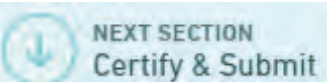
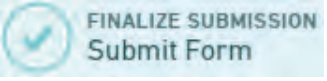
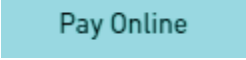
https://anonline.vermont.gov/?formtag=WSMD_Intake

1. Scroll to the bottom of the page and click the  button.
2. Log in to an account, sign up for an account, or continue as a guest user.
3. Fill out each field in the General Information Section.
 - Type the name of the contact person, phone, and email address.
 - Select the Watershed Management Division Program. *The program name is written at the top the application.*
 - Select 'Permit Application' as the submission type.
 - Click the  button at the bottom of the page.
4. Click "Choose File" and select your application, plans, maps, or compliance notifications.
 - Click the  button at the bottom of the page.
5. Type the application fee amount.
 - Click the  button at the bottom of the page.
6. Review your data.
 - Click the  button at the bottom of the page.
 - Click the  button at the bottom of the page.
7. Sign in or continue as a guest to pay the application fee.
 - Click the  button.
8. Enter your credit/debit card or eCheck information.
 - Click the  button at the bottom of the page. *Note: You must provide your email address in the billing information section if you want a receipt emailed.*
 - Your submission will now show the fee has been paid. You may print a confirmation/receipt from here if needed.



PERMIT ID# _____
 AMOUNT PAID _____
 CHECK # _____
 RECEIVED DATE _____
 ACCEPTED BY _____

**VERMONT AGENCY OF TRANSPORTATION
 State Highway Access and Work Permit**

FEE SCHEDULE

The applicant shall pay the applicable administrative processing and application review fee by submitting a check made payable to the “**State of Vermont**” to the following address:

Vermont Agency of Transportation
 Development Review and Permitting Services Section
 Barre City Place
 219 N. Main Street
 Barre, VT 05641

Municipal and State projects are **not** exempt from fees. Nonprofit organizations and companies are **not** exempt from fees. **Fees are not refundable.** Revisions and time extensions are free.

The Agency reserves the right to return an application that is incomplete, inaccurate or does not meet the requirements for a VSA, Title 19, Section 1111 Permit. The Agency may require an applicant to submit additional information that the Agency considers necessary in order to make a decision on the permit request. Calculate the fee using the table below (only **one** fee per permit)

Residential or Agricultural	\$0
Utility Installations	\$100
Minor Commercial Developments	\$250
Major Commercial Developments	\$2,500
Annual Utility Permits	\$500

Notes:

1. “Residential or Agricultural” means accesses serving a single-family home, a duplex residence, or a logging or field access for agricultural use only. Three or more dwelling units are considered a “Minor” or “Major” Commercial Development.” **All** land subdivisions are considered either “Minor” or “Major Commercial Development”;
2. “Utility Installations,” include each direct connection to the State highway storm water system;
3. “Minor Commercial Developments” means a commercial development for which the Agency does not require the applicant to submit a traffic impact study. Resurfacing or reconstructing an existing commercial access is considered a Minor Commercial Development;
4. “Major Commercial Developments” means a commercial development for which the Agency requires the applicant to submit a traffic impact study (in any case involving an access permit for a development contributing 75 or more peak hour trips to State highways based upon latest trip generation guidance by Institute of Transportation Engineers);
5. “Annual Utility Permits” are the Routine Maintenance and Emergency Repair Permits;
6. There exist other types of permits for which a fee is **not** required. Examples of these types of permits are; temporary traffic control signage, survey or boring work, sidewalks, installation of traffic counting devices, trailer-mounted or permanent speed radar feedback signs and regrading of a roadside ditch;
7. **Any questions please call the Permitting Services Office at (802) 279-1152**

PERMIT ID# _____

FOR AGENCY USE ONLY

Town: _____
Route: _____
Mile Marker: _____
Log Station: _____

**VERMONT AGENCY OF TRANSPORTATION
State Highway Access and Work Permit**

Owner's/Applicant's Name, Address, E-mail & Phone No. Vermont Fish and Wildlife, c/o Mike Wichrowski

1 National Life Dr, Davis 2, Montpelier, VT 05620, mike.wichrowski@vermont.gov 802-917-1347

Co-applicant's Name, Address, E-mail & Phone No. (if different from above) _____

The location of work (town, highway route, distance to nearest mile marker or intersection & which side)
Vermont Route 108 between Blackberry Hill Drive and Route 109 on east side of road

Description of work to be performed in the highway right-of-way (attach plan) Reconfigure the entrance to the Dorothy Smith Access Area to create a controlled entrance onto Route 108. The current configuration allows traffic to drive off of the highway along a long stretch of the road. Parking will be reduced stormwater controls will be installed and vegetation will be planted.

Property Deed Reference Book: b42 p371 Page: & b68 p50 (only required for Permit Application for access)

Fee \$ _____ (fees do not apply for residential or agricultural purposes)

Is a Zoning Permit required? Yes No - If Yes, # _____

Is a 30 VSA § 248 permit required? Yes No - If Yes, # _____

Is an Act 250 permit required? Yes No - If Yes, # _____

Other permit(s) required? Yes No - If Yes, name and # of each Stream Alteration, Floodplain, Ar

Date applicant expects work to begin July _____ 20 25

Owner/Applicant: Christopher Herrick Position Title: Commissioner

(Print name above)

Sign in Shaded area:

DocuSigned by: <i>Christopher Herrick</i> 77C8A4CF14447F...	Date: <u>11/13/2024</u>
---	-------------------------

Co-applicant: _____ Position Title: _____

(Print name above)

Sign in Shaded area:

	Date: _____
--	-------------

INSTRUCTIONS: -Contact the Development Review and Permitting Services Section (802.636.0037) or your local area Transportation Maintenance District Office to determine your issuing authority. The issuing authority will determine what plans, fee and other documents are required to be submitted with your Vermont Statutes Annotated, Title 19, Section 1111, permit application request.

- Original signatures are required on an original Form. The Owner/Applicant and Co-Applciant (if applicable) declares under the pains and penalty of perjury that all information provided on this form and submitted attachments are to the best of their knowledge true and complete.

FEE: -See **Fee Schedule** for applicable administrative processing and application review fee.

PERMIT APPROVAL

The work is subject to the restrictions and conditions on the reverse page, plus the Special Conditions stated on the attached page(s).

Date work is to be completed _____ Date work accepted: _____

By _____ Issued Date _____
Authorized Representative for Secretary of Transportation DTA or Designee

NOTICE: This permit covers only the Vermont Agency of Transportation's jurisdiction over this highway under Vermont Statutes Annotated, Title 19, Section 1111. It does not release the petitioner from the requirements of any other statutes, ordinances, rules or regulations. This permit addresses only access to, work within, and drainage affecting the state highway. It does not address other possible transportation issues, such as access to town highways, use of private roads, and use of railroad crossings. If relevant to the proposed development, such issues must be addressed separately.

No work shall be done under this permit until the owner/applicant has contacted the District Transportation Office at:

Applicant to Complete

RESTRICTIONS AND CONDITIONS**DEFINITIONS:**

"Agency" means the Vermont Agency of Transportation (a/k/a VTTrans).

"Engineer" means the authorized agent of the Secretary of Transportation.

"Owner/Applicant" means the party(s) to whom the permit is to be issued.

"Co-Applicant" means the party who performs the work, if other than Owner/Applicant or a secondary Owner/Applicant under a joint permit application.

"Permit Holder" means the party who currently owns the lands abutting the highway that are the subject of the permit.

GENERAL:

By accepting this permit, or doing any work hereunder, the Owner/Applicant agrees to comply with all of the restrictions and conditions and any imposed special conditions. If the Owner/Applicant is aggrieved by the restrictions and conditions or special conditions of the permit, they shall submit a written request for consideration to the Engineer within 30-days of permit issuance and prior to starting any work. No work will be authorized by the Agency, or performed under the permit, until the dispute is fully resolved.

Vermont Statutes Annotated, Title 30, Chapter 86 ("Dig Safe") requires notice to Dig Safe before starting excavation activities. The Permit Holder or his/her contractor must telephone Dig Safe at 811 at least 48 hours (excluding Saturdays, Sundays and legal holidays) before, but not more than 30 days before, starting excavation activities at any location. In addition, please note that the Agency and many municipalities are not members of Dig Safe and will need to have their utility facilities investigated with due diligence prior to starting excavation activities in or on the State Highway right-of-way.

The Permit Holder is to have a supervisory representative present any time work is being done in or on the State Highway right-of-way. A copy of this permit and Special Conditions must be in the possession of the individual performing this work for the Permit Holder.

Except with the specific, written permission of the District Transportation Administrator, all work in the State Highway right-of-way shall be performed during normal daylight hours and shall cease on Sunday, on all holidays (which shall include the day before and the day following), during or after severe storms, and between December 1 and April 15. These limitations will not apply for the purposes of maintenance, emergency repairs, or proper protections of the work which includes, but not limited to, the curing of concrete and the repairing and servicing of equipment.

The Owner/Applicant shall be responsible for all damages to persons or property resulting from any work done under this permit, even if the Applicant's Contractor performs the work. All references to the Owner/Applicant also pertain to the Co-Applicant.

The Owner/Applicant must comply with all federal and state statutes or regulations and all local ordinances controlling occupancy of public highways. In the event of a conflict, the more restrictive provision shall apply.

The Owner/Applicant must, in every case where there is a possibility of injury to persons or property from blasting, use a pre-approved Blasting Plan. All existing utility facilities shall be protected from damage or injury.

The Owner/Applicant shall erect and maintain barriers needed to protect the traveling public. The barriers shall be properly lighted at night and must be MUTCD (Manual on Uniform Traffic Control Devices) compliant.

All temporary and permanent traffic control measures and devices shall be MUTCD compliant.

The Owner/Applicant shall not do any work or place any structures or obstacles within the State Highway right-of-way, except as authorized by this permit.

The Owner/Applicant may pay the entire cost of the salary, subsistence and traveling expenses of any inspector appointed by the Engineer to supervise such work.

The Engineer may modify or revoke the permit at any time for safety-related reasons, without rendering the Agency or the State of Vermont liable in any way.

In addition to any other enforcement powers that may be provided for by the law, the Engineer may suspend this permit until compliance is obtained. If there is continued use or activity after suspension, the Engineer may physically close the work area and take corrective action to protect the safety of the highway users.

The Permit Holder shall be responsible to rebuild, repair, restore and make good all injuries or damage to any portion of the highway right-of-way that has been brought about by the execution of the permitted work, for a minimum period of eighteen (18) months after final inspection by the District.

Any approved variance from the permitted plans is to be recorded on "as-builts" with copies provided to both the Chief of Permitting Services and the District Transportation Administrator.

ACCESS:

This permit (if for access) does not become effective until the owner/applicant records in the office of the appropriate municipal clerk, the attached "Notice of Permit Action"

As development occurs on land abutting the highways, the Agency may revoke a permit for access and require the construction of other access improvements such as the combination of access points by adjoining owners.

Under Vermont Statutes Annotated, Title 19, Section 1111, no deed purporting to subdivide land abutting a state highway can be recorded unless all the abutting lots so created are in accordance with the standards of Section 1111.

The Permit Holder acknowledges and agrees that neither this permit nor any prior pattern of use creates an ownership interest or other form of right in a particular configuration or number of accesses to or through the highway right-of-way, and that the right of access consists merely of a right to reasonable access the general system of streets, and is not a right to the most convenient access or any specific configuration of access.

DRAINAGE:

The Owner/Applicant shall install catch basins and outlets as may be necessary, in the opinion of the Engineer, to preclude interference with the drainage of the state highway. Direct connections shall not be allowed without written approval.

UTILITY WORK; CUTTING AND TRIMMING TREES:

The Owner/Applicant shall obtain the written consent of the adjoining owners or occupants or, in the alternative, an order from the State Transportation Board in accordance with, Vermont Statutes Annotated, Title 30, Section 2506, regarding cutting of or injury to trees.

In general, all utilities shall be located adjacent to the State Highway right-of-way boundary line and shall be installed without damaging the highway or the highway right-of-way. No pole, push-brace, guy wire or other aboveground facilities shall be placed closer than 10 feet to the edge of traveled-way. If the proposed utility facilities are in conflict with the above, each location is subject to the approval of the Engineer.

Poles and appurtenances shall be located out of conflict with intersection sight distance, guardrail, ditches, signs, culverts, etc.

Where the cutting or trimming of trees is authorized by permit, all debris resulting from such cutting and trimming shall be removed from the State Highway right-of-way.

Open cut excavation for highway crossings is NOT the option of the Applicant, and may be utilized only where attempted jacking, drilling, or tunneling methods fail or are impractical. The Owner/Applicant shall obtain an appropriate modification of the highway permit from the Engineer before making an open cut.

JOINT PERMITS:

A joint permit application is required when more than one party will be involved with the construction, maintenance, and/or operation of the facility being constructed under this permit. Examples include, but are not limited to, joint ownership or occupancy of a utility pole line and construction of a municipal utility line by a contractor. Both utility companies, and in the second case, the municipality and the contractor, must be joint applicants.

DOROTHY SMITH
ACCESS AREA
FLOODPLAIN
RESTORATION
PROJECT-
IMPLEMENTATION
PHASE



Presented by: Meghan Rodier, Regional
Planner, Lamoille County Planning
Commission

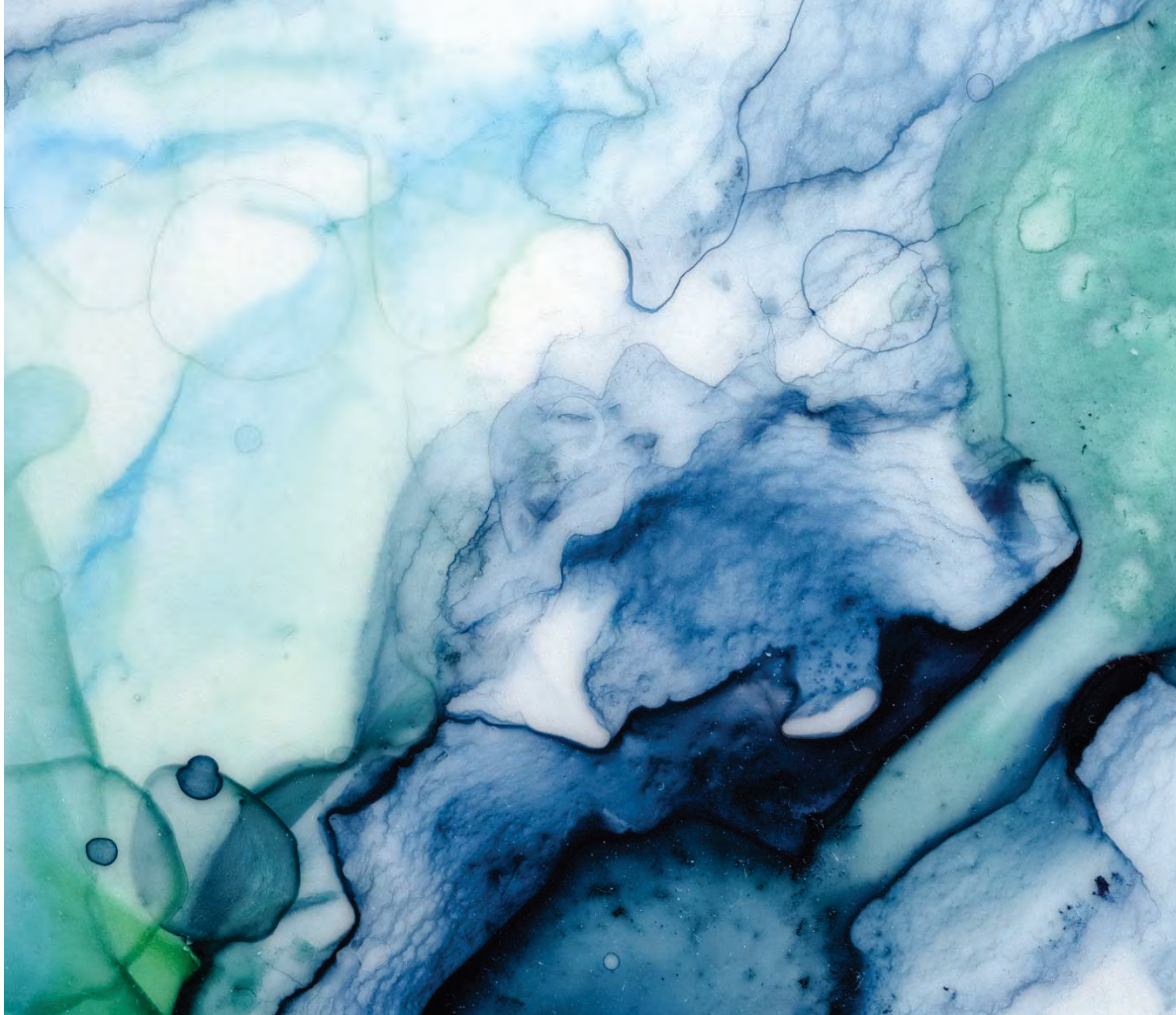

PROJECT AREA

- Located immediately upstream of the confluence of the Brewer and Lamoille Rivers in Jeffersonville Village in Cambridge
- Located upstream of the VT 108 Bridge
- Crucial location for ice, debris, and sediment to settle out, to reduce sedimentation inputs and phosphorus loading into the Lamoille River
- On VFWD owned land outside the VTTrans ROW

Dorothy Smith Access Area

Vermont Agency of Natural Resources

vermont.gov



LEGEND

- Wetland - VSWI
 - Class 1 Wetland
 - Class 2 Wetland
 - Wetland Buffer
- Wetlands Advisory Layer
- River Main Stem Waterbodies
- WBID Watersheds
- River Corridors (Aug 27, 2019)
 - .5 - 2 sqmi.
 - .25 - .5 sqmi.
- DFIRM Flood Hazard Areas (C FEMA-digitized data)
 - AE (1-percent annual chance flood)
 - A (1-percent annual chance flood)
 - AO (1-percent annual chance zone feet)
 - 0.2-percent annual chance flood/ha
- Soils - Hydric
- Parcels (standardized)
- ACT250 Permits
- Town Boundary

NOTES

PROJECT BACKGROUND

- ❑ Included in 2021 Cambridge/Jeffersonville Stormwater Master Plan as an erosion hot spot
- ❑ One of two restoration-based projects included in the Stormwater Master Plan
- ❑ Due to the floodplain restoration concept and restoration-based alternatives proposed the project was entered into VT Watershed Database as a “Floodplain Restoration” Project for the whole site
- ❑ Proposed alternatives are designed to become part of the natural landscape



Post July 2023 Flood, Dorothy Smith -Upper Access Area

PROJECT FUNDING

- Preliminary Design funded by combination of VT DEC DIBG and ERP Grants
- Final Design/Permitting Phase funded by VT DEC DIBG
- CWSP Request for implementation \$219,265 (includes construction, construction oversight, LCPC Project Management, 3-year post monitoring/O/M cost)



PROJECT SCOPE-LOWER ACCESS AREA

- Lower floodplain/create floodplain cut
- Remove gravel / restore floodplain
- Revegetate floodplain with seed mix and trees
- Narrow existing access road to 6ft wide walking path to boat access



Post July 2023 flood, Dorothy Smith Access Area
-Lower Access Area



PROJECT SCOPE-UPPER ACCESS AREA

- Plant/stabilize eroding streambank (Willow live stakes/ bare root trees)
- Remove asphalt/revegetate and restore riparian habitat
- Remaining parking lot space will form a more controlled access point
- Retain a 6ft walking path from remaining parking area
 - For fishing access in upper access area
 - To lower boat access



Dorothy Smith Access Area
-Upper Access Area

PROJECT BENEFITS

- Increases floodplain access
- Provides flood storage capacity
- Provides space for debris, sediment to settle out and reduce ice/debris jams by VT 108 bridge
- Restores riparian habitat
- Enhances recreational space
- Reduces phosphorus loading

Estimated Phosphorus Credit for Stream Stability and Storage			
SubUnit(s) ID: 16_R08--7_C00 16_R08--1_C00			
Town: CAMBRIDGE			
Projects Included: Plant Floodplain, Lower Floodplain			
Stream Name(s): -			
Project Area (acres): 0.8999999999999999			
Stream Stability and Storage Credit Summary			
	Year 1 Credit (kg)	Year 2+ Credit (kg/yr)	Estimated 15 Yr Lifespan Credit (kg)
Floodplain Connectivity (Lateral - Vertical)			
Stream Stability	0.1	0.1	1.5
Storage	6.2	2.8	46.2
Stream Connectivity (Longitudinal - Temporal)			
Stream Stability	0.0	0.0	0.0
TOTAL	6.3	2.9	47.7

PROPOSED PROJECT TIMELINE

Project Schedule

Dorothy Smith Access Area Floodplain Restoration Project - Implementation

Please see below a proposed project schedule for the implementation phase based on anticipated milestones. This schedule is subject to change based on when this project receives funding for implementation.

Milestone	Milestone Completion Timeline
Permits Filed	Filed in November, 2024
Required permits secured	February 1 st , 2025
Project initiated; RFB issued	February 15 th , 2025
Contractor selected	April 1 st , 2025
Pre-Construction Meeting	June 30, 2025
Floodplain Restoration project implemented (construction phase)	October 1 st , 2025
Final Reporting Submitted	December 1 st , 2025

8. Updates/Announcements/Conclusion